



C.D.A.A. Newsletter

GUIDELINES

No: 69 - AUGUST 1999



CAVE DIVERS ASSOCIATION OF AUSTRALIA

(Incorporated in South Australia)

Print Post No. PP 381691/00020

At Zeagle we think of our equipment as a system, custom tailored to make your diving safer and more enjoyable.

Shoulder system can be selected for size, D-ring configuration and style.

Zeagle regulators offer the highest performance in a range of configurations suitable for every diving environment.

Zeagle Status II dual mix nitrox computer enables up to 100% oxygen for deco stops and many user adjustable options for individual setup.



Bladder assemblies can be selected for style, material and amount of buoyancy.

Vest section of the BC incorporates a weighting system and can be selected for sizing, attachment style and whether single or dual tanks will be used.

Waist closures have a wide range of adjustment and come in a variety of closure configurations.

PFS

The Personal Fit System

All Zeagle buoyancy systems are constructed from modular interchangeable components. This makes it easy to custom fit each and every system to the diver. Torso length is sized by changing the shoulder section; waist size by selecting the proper vest style and size. Further adjustments are provided by multi position elastic waist panels. Component styles can be mixed as well - some BC models give the diver the option of different bladder styles and weight systems. Several models allow the diver to easily switch between single and twin cylinders. You and your Zeagle dealer can build a custom diving system perfectly tailored to your needs.

Proudly distributed in Australia by
Divers Supplies Pty Ltd
43 Hinkler Road, Braeside, Vic 3195
Phone (03) 9580 5666



Integrated Diving Systems

Editorial

Hello to everyone,

At this time of the year I would urge all members to consider taking on a C.D.A.A. position. For a long time a lot of work has been done by a few and we seem to be seeing a "changing of the guard", which is really good to see.

There is a lot of information about new diving conditions in Tank Cave. *Read Carefully!*

Also, please send me some interesting articles.

Glenn O'Connell
Editor

ARTICLES FOR GUIDELINES

Members wishing to submit articles for inclusion in guidelines can do so in the following manner:

- Send articles & photos via post to:
The Editor, Glenn O'Connell,
P.O. Box 290, North Adelaide, S.A. 5006.
- Email to glenn@vds.net.au
- Any files for inclusion should be saved in "TEXT" or "ASCII" format. Hardcopy should also be provided wherever possible.

ADVERTISING RATES

FOR SPACE - APPLY TO THE EDITOR

"Guidelines" magazine is circulated to over 1200 members and retail outlets.

Back Page	2 colour	\$350.00
Inside Front Page	Black & White	\$300.00
Inside Back Page	Black & White	\$300.00
Full Page	Black & White	\$250.00
Half Page	Black & White	\$150.00
Quarter Page	Black & White	\$100.00

CONTENTS

Editorial	3
The Nullarbor WA – What It Takes	6
Special Site Information Bulletin No. 7 5L230 – Tank Cave	10
Special Site Information Bulletin No. 6 5L158 – The Shaft	16
Letter of Thanks	20
Underwater Cave Rescue	21
CDAА Site Access	26
Trading Post	28
CDAА Notices	29
CDAА Products	31

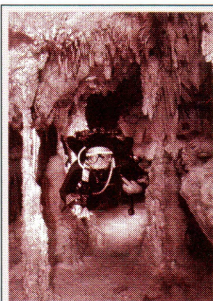

Front cover:

Robert Smith down in
"Systema Sac Actun",
Tulum, Quintana Roo,
Mexico in May 1998.

Photo by
Steve Gerrard

CAVE DIVERS ASSOCIATION OF AUSTRALIA

P.O. BOX 290, NORTH ADELAIDE,
S.A. 5006

GUIDELINES is a newsletter of the Cave Divers Association of Australia. All articles for the following issue are to be sent to the Editor, Glenn O'Connell, P.O. Box 290, North Adelaide, S.A. 5006. All articles and submissions shall automatically constitute an expressed warranty by the contributor that the material is original. We assume no responsibility for unsolicited material. Articles and information may be reproduced without prior permission provided reprints are accredited to the authors and GUIDELINES. Private advertising for caving and diving equipment may be advertised free at the discretion of the Editor. Opinions expressed in GUIDELINES are those of the individual authors and are not necessarily those of the C.D.A.A.

CDAА DIRECTORY

The following is a list of people that can be contacted for CDAА matters. Please contact the most relevant person or, if unsure write to:

C.D.A.A. P.O. Box 290 NORTH ADELAIDE S.A. 5006

If you know who you want to write to, please address your letter to the relevant director.

NATIONAL DIRECTOR

Steve Sturgeon 0418 940 143 (mobile) (08) 9527 7667 (work)
P.O. Box 5233 Rockingham Beach (08) 9528 6995 (fax)
Western Australia 6168 Email: cdaa@nitrox.com.au

MANAGER RESEARCH & MAPPING

Gary Barclay (03) 5565 8793 (home) (03) 5565 8118 (fax)
P.O. Box 15 Koroit Victoria 3282 garinda@tpgi.com.au

STANDARDS DIRECTOR

Glen Harrison 0407 608 609 (mobile)
24 Broadbeach Drive harrison.glen@sa.gov.au
Maslin Beach South Australia

Investigations Officer

Noel Dillon (03) 5528 4589
PO Box 112, Queenscliffe, Vic. 3225

Instructor Materials

Deb Williams (03) 9543 3930
80 Mantion Road, Clayton Victoria 3168 deb@agentis.com.au

Instructor Records

Linda Claridge (03) 5565 8793 (home) (03) 5565 8118 (fax)
PO Box 15, Koroit, Victoria 3282 garinda@tpgi.com.au

BUSINESS DIRECTOR

Carlo Virgili 0411 242 900
PO Box 1589, Adelaide 5001 carlovir@tafe.sa.edu.au

Treasurer

Andrew Seifried (08) 8379 4013 (home) seifried@senet.com.au

SITE DIRECTOR

Steve Arnell (03) 5526 5230 (home)
2332 Holmes Road Portland 3305

PUBLICATIONS AND RECORDS DIRECTOR

Chris Edwards 0417 116 372 (mobile)
cedwards@teksupport.net.au

Records Officer

Linda Claridge (03) 5565 8793 (home) (03) 5565 8118 (fax)
PO Box 15, Koroit, Victoria 3282 garinda@tpgi.com.au

Editor

Glenn O'Connell 0411 704 758 (mobile) glenn@vds.net.au

CDAА products

Chris Edwards 0417 116 372 (mobile)
cedwards@teksupport.net.au

Phil Argy (08) 8723 0879 (home) blinkbonney@seol.net.au

CDAА Advertising

REPRESENTATIVES

Victoria

Warrick McDonald (03) 9579 2600 (work)

New South Wales

Andrew Robertson (02) 525 0995 (home) 018 412 563 (mobile)
aroberts@awa.com.au

South-east (Emergency only)

Phil Argy (08) 8723 0879 (home) blinkbonney@seol.net.au

RETURNING OFFICER

Jim Ferry jvcferry@bold.net.au
12 Grand Central Avenue Hallett Cove South Australia 5158

PUBLIC OFFICER

Kevin Burrows
11 Oakfield Avenue Clarence Park South Australia 5034

CDAА INSURANCE

Insurer: Jardine Underwriting Agency Pty Ltd
Policy number:
Coverage: \$10,000,000 public liability coverage
Expiry date: 11/7/99

As a recreational or technical diver your most important piece of equipment, your lifeline, is your regulator.

The Poseidon range of regulators has incorporated the highest performing technologies into unique designs, which ensure both your safety and your comfort regardless of your angle in the water.

In addition, these regulators have been tried and tested in all types of environments, whether it be warm or cold water and, at depths ranging from just beneath the surface to 282.6 meters.

The Jetstream The ultra-high performance regulator offering extreme breathability regardless of depth or work rate. In short, the standard by which all other regulators are judged.



The Cyklon 5000 The legend. "Top Class" rated. Specified by commercial divers. Popular with cave and technical divers alike. Used by many of the world's navies. The one which built Poseidon's reputation for reliability.



For many years, divers have selected Poseidon as their ultimate buddy. Make the only choice, make the safest decision and dive with Poseidon.

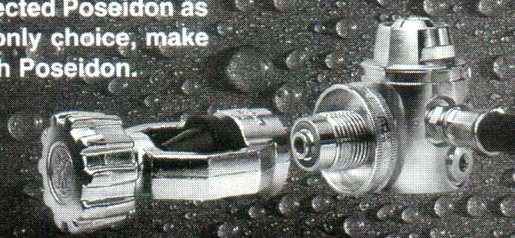

innovative [since 1958]

POSEIDON

DIVING SYSTEMS



Poseidon Diving Systems (Australia) - Tel: (02) 9904 8440 Fax: (02) 9904 8447
Website: www.poseidon.se

Design: Lateral Vision

THE NULLARBOR WESTERN AUSTRALIA

- WHAT IT TAKES -

By Steve Trewavas & Chris Ross

In June 1998, a small party of divers left for a 12 day trip to dive four Nullarbor Caves. As a result, this article has been written to supply information which will assist with future expedition planning. It is particularly directed toward those who are arranging their first excursion into the West.

This article is authored by Melbourne based divers and includes the expenses incurred by us, to Cocklebidy and back. We drove a petrol engine Holden Jackaroo, towing an air compressor on the way over but without it on the return journey, having left it for divers with longer holidays than ourselves.

We travelled direct to Mount Gambier, a convenient staging point for meeting with other participating divers. The four and a half hour trip culminated in a night at Blink Bonney Lodge with our host and voluntary expedition guide, Phil Argy, very receptive as always.

On Saturday we left Gambier at midday and drove direct to Port Augusta, (8 hours), spending a night in a local motel. From Port Augusta we drove to Bordervillage, South Australia (11 hours), again resting at a motel for the night. On Monday morning a short 3 hour drive saw us arrive safely at Cocklebidy Roadhouse, Western Australia.

In hindsight a trip from Melbourne to Port Augusta and then direct to Cocklebidy would be our recommended route. Bear in mind that arriving at Cocklebidy at night and attempting to find a cave in darkness is not a recommended option. Remember to

bring your sunglasses, time travelling West into the sun, strains the eyes.

From the roadhouse we drove 17 kms (30 mins.) to Tommy Grahams Cave. Here we planned to set up base camp and dive Cocklebidy, Tommy Grahams and Murra El-elevyn. All within 20 kilometres of Cocklebidy Roadhouse itself.

Geography

For the benefit of first time visitors, the Nullarbor Plain is an extensive area of relatively flat ground, covered with Ti-tree and low shrubs. All tracks are negotiable by two wheel drive sedans whilst dry, but four wheel drives or at least a vehicle with a decent ground clearance would be highly recommended, if not a necessity when wet.

Weather Conditions

The weather at the time of our visit, late June to early July, was overcast and cool, only 21 degrees – surprised us too! Bear in mind this area is relatively close to the south coast of Australia and subject to coastal weather.

The Caves

The scope of this article isn't to include descriptions of the dives themselves. Other authors have described them previously (simply world class). We set up base camp at Tommy Grahams Cave although the pick of campsites for centrality and convenience would be Murra El-Elevyn.

Hot showers and water can be obtained from Cocklebidy Roadhouse but don't rely on it especially in Summer where a fee will be charged, if the service is provided at all. Extensive time is taken up with getting in and out of the holes. Plan on diving only once for every day you intend staying.

These are our suggestions which should be considered in the planning phase:

- Consider diving independents. Manifolds are impractical to handle in the dry cave restrictions
- Bags rugged and tubular if possible
- Overalls, knee pads and gloves for protection
- Tank valve plugs
- Hard cases for torches, masks and dive computers
- Slings for ease in carrying tanks. Band tanks at the lake surface.
- Line arrows
- Dry cave guideline from surface to waters edge – essential in Tommy Grahams.
- Equipment lowering frame and spares
- Abseiling equipment
- Rigid ladder or two
- Maps to get to each site
- Torches and spares for dry caving

Tommy Grahams Cave

Tommy Grahams has two sumps separated by an air chamber which can be traversed to find an entirely different dive. The air chamber has a high carbon dioxide level, so be warned, take it slow and easy or travel with your regulator in your mouth. Once you loose your breath it is extremely hard to regain it.

In order to access the water divers must first locate the cave entrance which is at the top of

the doline. Divers must then crawl through a restriction which is approximately 1 metre wide, 2 metres long and 80 centimetres high. The dry cave is low and steep and there are two subsequent restrictions that are also difficult to negotiate. On the plus side there is no equipment lowering required. The use of small capacity tanks may be beneficial in Tommy's, perhaps twin 55's.

Depth: 25 metres
Temperature: 24 degrees
Distance: 320 metres

Murra El-Elevyn

Murra is situated (15 minutes) 6 km West of Cocklebidy Roadhouse and 1 km south of the Eyre Highway along an easy dirt track. A comfortable 10 metre ladder climb enables you to reach the floor of the doline. Equipment may be lowered from the other side 40 metres to the ground. An equipment frame is essential facilitating both lowering and raising of gear. A relatively steady downhill walk for about 300 metres takes you to the entrance lake. Murra is filled with extensive passages that extend for an underwater distance in excess of 300 metres and dive times longer than an hour were the norm.

Depth: 14 metres
Temperature: 19 degrees
Distance: 540 metres

Cocklebidy

Cocklebidy Cave is 12 km West of the roadhouse and a further 10 km drive North of the Highway (20 minutes). A forty metre face is the best place to lower dive gear directly to the entrance of the cave itself. From here a three hundred metre walk inside an extensive cavern enables the divers to reach the 250 metre long surface lake. A good flat shore is

provided which facilitates easy gear preparation. A 250 metre surface swim across the lake brings you to the far end where a fixed line is attached to the wall. From here a swim of about 750 metres brings you to the first of two caverns which both require a 100 metres surface swim with a short 80 metre sump between them. The second cavern lake ends in a rock collapse commonly called "The Rockpile". By sticking to the roof, we had a maximum depth of 10 metres and a minimum of 5. Swimming from the start of the guideline to "The Rockpile" took us 43 minutes. The Rockpile is approximately 60 metres long and 15 metres high. The air is good and a great place to rest and take photographs. Maximum depth found by us in the cave was 16 metres. Cocklebiddy cave is a straight run with the tunnel 20 to 30 metres wide and 10 metres high.

Depth: 16m
Temperature: 19 degrees
Distance: 900 metres

Weebubbie

The next stage of our trip was a 273 kilometre, 3 1/2 hour, drive to Eucla Roadhouse. Accommodation for one night for 2 persons \$33.00. This was to be our base for a one day visit to Weebubbie Cave.

Weebubbie has a magnificent camping area with great views and shelter. The Doline is approximately 150 metres by 60 metres across and a 45 metre vertical drop to the cave entrance. It is 16.6 km from the Eucla Road House from where directions can be sought.

With the assistance of the South Australian contingent we placed 2 aluminium ladders to aid us with two pitches to the base of the Doline. These aren't essential but were a

great idea. A permanent wooden ladder is in place at the base of the entrance to negotiate a difficult slope. There is then a reasonably sedate reflector marked track to the waters edge, approximately 200 metres from the entrance. A 200 metre surface swim to the far end of the lake finds a permanent line on the floor leading into the crystal water filled cavern.

The dive is deep, in the vicinity of 50 metres and decompression is a definite planning consideration.

Depth: 50 metres
Temperature: 19 degrees
Distance: 400 metres

Cocklebiddy Motel Alternative

Short overnight stays in any of the roadhouses across the Nullarbor are expensive. If you phone ahead and book for a week, the management at Cocklebiddy Roadhouse state that for \$10 per person, per night, a two bed room can be supplied. Meals can be negotiated for a further fee. Bare in mind this was negotiated at the time, prices and negotiating skills fluctuate. A warm bed, hot shower and no noisy generators recharging batteries are a serious argument for this option. But then again, camping is all part of the experience.

Return Trip

The return was short and fast. Two drivers non-stop, 22 hours Eucla to Melbourne. We recommend an overnight stop somewhere near Adelaide as the smaller towns generally have cheaper fares.

Kilometres

In total: 5472.7 km.

Petrol

Petrol varied in cost from 68 cents p/l in Adelaide to 99.9 cents p/l at Cocklebiddy.

Vehicle Service

Remember to factor this in. You will be travelling in excess of 5000 kilometres and a service will be required upon your return.

Cost For Two People

Item	Cost
Petrol	\$776.28
Food	\$165.00
Roadhouse Accommodation	\$200.20
Road Map	\$5.00
Counter Meals	\$91.00
Travel Snacks	\$60.00
Oil	\$25.95
Vehicle Service	\$300.00
Batteries	\$26.00
TOTAL	\$1,649.43

Single Greatest Tip

Go with someone who has been before.

Acknowledgments

Thanks to:

- **Phil Argy** of **Blink Bonney Lodge** for guidance and direction
- **Aqualung Australia** for assistance and supply of additional equipment.
- **Diver Instruction Service – Doncaster** for assistance during the initial planning stage

CDAA

WEB PAGE

<http://artemis.eng.monash.edu.au/CDAA/>



SPECIAL SITE INFORMATION BULLETIN

• NUMBER 7 •

5L230 – TANK CAVE

This Bulletin replaces Special Site Access Bulletin Number 5, 5L230 – Tank Cave

This is the seventh in a series of Special Site Information Bulletins which have been prepared for the education and interest of Cave Divers Association of Australia (CDAA) members and the general public. It highlights special values and/or considerations felt to be of importance at cave diving sites.

Introduction

Tank Cave was reopened in 1992, following a three year closure because of access problems relating to public liability. Initially limited access was granted to survey and reline certain areas of the cave, with the view to allowing more general access in the future. From October 1993, for four years, CDAA members enjoyed diving in Tank Cave. During this time, pressure was being placed on the Association to increase the scope and value of public indemnity cover, thereby ensuring more comprehensive protection for land managers and owners in the event of an accident.

Whilst members sign indemnities declaring responsibility for their actions, this does not stop insurers, spouses and families from attempting to recover losses from the land owner/manager or the Association in the event of an accident. It became necessary for the Association to provide a more comprehensive cover or current access arrangements could be jeopardised. This situation particularly affected the arrangements at Tank Cave where access remained problematic because of the landowners specific diving related requirements. These together with the need to increase access resulted in Tank Cave remaining closed since last July. The decision was not an easy one

and it was made in the best interests of the landowner and the Association.

In mid 1998, when the Association entered into discussions for renewed access two critical issues had to be addressed. The first being that Tank Cave had now closed for a second time (totaling nearly five of the last nine years) because of public liability issues and the second, that the former access arrangements were too limited. Agreement was reached and the Association entered into a licence arrangement for a period of two years at a fixed rent per year. This arrangement shifts more responsibility to the Association but also allows the Association to manage diving at the site.

The new arrangements apply to all divers intending to dive in Tank Cave, including those who gained access under the former arrangements and cave diving supervisors.

Cave Diving Supervisors

Tank Cave is a supervised dive site and as such diving can only take place on scheduled times and under the supervision of a CDAA cave diving supervisor. Scheduled times and Tank Cave cave diving supervisors are specified in Guidelines. The presence of cave diving supervisors on site during dives will

ensure that divers enter and exit the property in a safe and organised manner, that dives are conducted safely and that diving groups are coordinated. Cave diving supervisors are responsible for giving a dive brief, including an accident management plan and ensuring that the CDAA's rules as well as the provisions of the licence are adhered to. Cave diving supervisors have the full support of the National Committee and their directions must be adhered to at all times. They have the authority to deny access in the event of:

- Inappropriate diving equipment configuration or poorly maintained diving equipment.
- Inappropriate attitude or behaviour.
- Failure to follow directions.

Cave diving supervisors are performing a service for the Association and its members and because their costs are not reimbursed a strategy to help share their travel costs has been put in place. This system will ensure one of the 6 diving spots per day remains available so that it may be booked, in the normal manner, by a diver who will travel with and share the cave diving supervisor's costs. The Tank Cave booking system does not allow more than one advance booking for any diver, therefore any diver booking under this strategy is not able to book again until after the dive has been completed. Please refer to the section on returning divers and currency for a detailed explanation of the booking system.

Tank Cave Familiarisation Schedule

The Tank Cave Familiarisation Schedule is designed to help divers plan dives, which will progressively familiarise them with Tank Cave, (*please refer to Appendix 1*). To allow the flexibility necessary to accom-

modate several dive teams the dives are organised into groups and dives within these groups can be conducted in any order. Whenever more than one dive team requires the same dive to complete a group of dives, then the dive supervisor will schedule such dives.

Each group of dives builds on previous knowledge; groups must be completed consecutively. Group 4 dives are optional; they can be conducted at anytime after group 3 dives are completed. They are not required to complete the schedule.

The scheduled dives are a minimum and divers may wish to repeat any dive(s) in order to become more familiar.

So that diving may be coordinated on the day, dive plans must be submitted to the dive supervisor on site before diving. Dive plans must be followed except if the dive is aborted.

The Application

The Tank Cave Application Form is to be used by all members, both those who have previously dived in Tank Cave as well as those who are applying to dive for the first time. This form together the application fee of \$220 must be forwarded to:

The Treasurer, Tank Cave Diving
C/- Box 290 North Adelaide SA 5006.

The Treasurer will process your payment and forward the application to the Tank Cave Access Manager.

Divers wishing to dive in Tank Cave and who have completed a penetration course prior to **30 June 1998** must pay the application fee of \$220. Divers qualifying to dive in Tank Cave after **30 June 1999** will be charged a pro-rata application fee. Pro-rata fees are stipulated on the application form.

Please take time to complete the application carefully, if you require any clarification please contact the Tank Cave Access Manager, Jim Ferry on 0417 862 351. Application fees will not be refunded and initially priority will be given to getting members diving, not following up on poorly prepared or incomplete applications.

All divers wishing to dive in Tank Cave must meet the following pre-requisites:

- Hold the CDAA rating of Penetration.
- Read, understand and agree to comply with the provisions of this Special Site Access Bulletin.
- A broad range of experience in penetration sites including:
 1. Exposure to **restrictions** (where single file access is required to pass).
 2. **Limited visibility** (where visibility has been reduced to less than one metre on part of the dive).
 3. **Isolation** (where the distance from the entrance is greater than 150 metres underwater).

This post course dive experience must be achieved by either:

Method (1):

Twelve months experience after completing your penetration course, if your experience is limited to dives undertaken in a single region. This experience must include a minimum of 20 post course penetration dives in at least 4 different CDAA approved penetration sites. (**Multiple Dives done between air spaces count as a single dive**). 10 of the 20 pre-requisite dives must be undertaken using an equipment configuration suitable for Tank Cave, that is, twin independent cylinders.

OR Method (2):

Nine months experience after completing your penetration course, if your experience has been gained in more than one region. (Examples of regions include Mt Gambier, Nullarbor, Florida, Mexico etc.). This experience must include a minimum of 20 post course dives in at least 4 different CDAA approved penetration sites. To qualify for method 2, at least four of these dives must have been done in another region. (**Multiple Dives done between air spaces count as a single dive**). 10 of the 20 pre-requisite dives must be undertaken using an equipment configuration suitable for Tank Cave, that is, twin independent cylinders.

Note: All new divers must complete a minimum of four such dives in the six month period prior to diving in Tank Cave.

If you have already dived in Tank Cave it is important that your diving experience is assessed against the familiarisation schedule. This will enable divers who had progressed beyond the initial gold line dives to resume in Tank Cave at a level commensurate with their experience.

After completing this section of the application form you may find that you have undertaken dives which fall into several groups without completing any specific group. If you are in this situation, you will be assessed at the lowest uncompleted group and must complete all dives within this group before progressing to the next higher group.

Dives you have completed in higher groups do not have to be repeated. All dives listed on the application form must include the date, the name of your buddy(s) and details of the dive proving that you have satisfied the requirements of the familiarisation schedule. Please ensure that this section is

completed thoroughly and accurately. Inaccurate or misleading information may see the application being rejected. **The application fee is not refundable.**

All divers have the opportunity to specify 3 preferred dive dates. Please refer to the enclosed Tank Cave Diving Schedule and indicate your preference and availability on the application form.

When the application and fee has been processed by the Treasurer it will be forwarded to the Tank Cave Access Manager, who will verify that all pre-requisites have been met. The Tank Cave Access Manager will allocate your diving date based on your preferences. Initially, because of an anticipated rush you will be booked in for one day only. Generally after this initial rush or if there is no rush, a weekend period will be scheduled which will normally include 2 dives on each of the 2 days. (On occasions, where there are more than 2 days diving possible, then the remaining days will be made available to the first group, only if no other group has applied to dive).

The Tank Cave Access Manager will advise you by letter when your application has been successfully processed and your diving scheduled.

Returning Divers and Cave Diving Currency

It is important that all divers maintain a certain level of diving currency. Currency can be maintained by undertaking four dives in CDAA approved penetration level sites within the last six months or four dives in caves not approved by the CDAA (eg overseas sites. All applications of this nature must show evidence of similar dive conditions to those described).

Dives should include a broad range of experience in penetration and cave sites which include:

- Exposure to **restrictions** (where single file access is required to pass).
- **Limited visibility** (where visibility has been reduced to less than one metre on part of the dive).
- **Isolation** (where the distance from the entrance is greater than 150 metres underwater).

If you have not maintained diving currency but have completed group 1 dives you will be able to establish currency by undertaking two dives on the gold line. After undertaking these dives you will be considered current and able to resume your diving status.

Cave diving currency is based on the information provided in your application.

If you plan to dive with another diver(s) please list their name(s) in the appropriate place on the form. Each diver in the group must lodge a separate application form. Please note that large groups are more difficult to accommodate than small groups.

Please include a stamped self-addressed envelope. This will ensure that your application is handled as quickly as possible.

General Diving Information

- The maximum number of divers per day is 6, not including the cave diving supervisor.
- Generally 2 twin tank dives or one stage dive per day will be possible.
- Times on and off the property will be advised when your booking is confirmed; these will be reconfirmed on the dive day. Generally you will be expected to meet at

the front gate to the property, located about 25 km from Mt Gambier on the Millicent road at 8.45 am and exit the property by 5.30 pm. Departure times for Sunday or the last day of a long weekend will vary depending on the cave diving supervisor's travel requirements.

- Diver propulsion vehicles are not allowed in Tank Cave.
- Manifold tanks are not allowed in Tank Cave.
- Divers are asked not to touch or remove any bones or remains from the cave. Divers should report such observations to the cave diving supervisor.
- No go zones will exist from time to time for a variety of reasons including mapping or surveying. Divers will be advised of these on the dive day.
- A reference section has been declared, it is known as the 'Easter Extension'. Access is not permitted to this section of the cave. Divers must not place a jump from and proceed beyond station 'E4' and must not place a jump from and proceed beyond station 'F3'.
- Visual jumps and 'trust me dives' are not permitted.
- At least one person must remain at the surface at all times.
- Except for National Committee approved exploration projects dives are only permitted in areas of the cave where lines are present and are recorded on the published map.
- Divers must be proficient in the use of diving equipment; Tank Cave is not a training site. For example divers intending to use side mounts to access certain areas of the Tank Cave must be proficient in the use of sidemounts prior to diving in Tank Cave.

The Dive

On the day of the dive you will meet the cave diving supervisor at the time and place specified when your booking was confirmed. You will be required to produce your current CDAA membership card. **No card, no dive!**

Generally divers entering and leaving the property will only be permitted to enter and exit once per day unless prior arrangements have been made with the cave diving supervisor. Divers are strongly advised to bring sufficient cylinders to undertake the planned days diving.

Car access is at the discretion of the cave diving supervisor. Normally three cars will be allowed to enter the property on any given day but this will depend on factors such as rain. There have been instances when cars have not been allowed to enter the property and divers have had to carry their equipment across the paddock. Once on site the cave diving supervisor will brief divers on all aspects of the days diving.

New divers (if without a buddy) may be introduced to another new diver and will be accompanied by a cave diving supervisor on the first two dives. A detailed map of the cave will be available and you will be asked to select the section of the cave you would like to visit and then plan accordingly.

The only restriction placed on you will be to choose one of the four primary routes with gold line and follow the agreed dive plan. Divers who would like to dive the complete 'circuit' must first dive both ways along the 'circuit'.

Once the dive team has decided on a dive plan (within the limits of the familiarisation schedule) it must be communicated to the cave diving supervisor.

Appendix 1

Tank Cave Familiarisation Schedule

(May 1999)

Group 1 dives

A minimum of 5 dives to familiarise with the main 'gold' lines:

- A tunnel
- B tunnel
- C tunnel

Notes:

- (i) The first two dives must be done with a dive supervisor.

Group 2 dives

A minimum of 3 dives to familiarise with secondary routes:

- J Tunnel
- D Tunnel (Do not try to enter the dangerous air chamber at end of D tunnel)
- F Tunnel
- K Tunnel

Notes:

- (i) Only jumps from the main 'gold' lines are allowed.
- (ii) All of the above tunnels must be accessed via main 'gold' line, no short cuts.
- (iii) At least 3 different tunnels must be dived, F Tunnel is a compulsory dive.

Group 3 dives

A minimum of 3 dives to familiarise with shortcuts.

- main 'gold' line shortcuts to D F, K, J and L tunnels

Group 4 dives (optional)

A minimum of 3 dives to familiarise with the S section:

- S Section main route (jump at B4 to line leading to S section, follow line via S1 and 'T's at S2, S3, S9, S10, S4, stop before restriction at rockpile just before S16).
- S Section circuit (jump at B4 to S section, follow line via S1 and 'T's at S2, S5, S6, S7, S8, S9 then back via S3, S2, S1).
- S Section (jump at B4 to S section, follow line via S1 and 'T's at S2, S3, S9, S10, S4 then to

S11 to explore the lines beyond. Do not attempt jump at S17).

Notes:

- (i) Almost all the S section lines are 'T'-ed in with very few jumps.
- (ii) The above order of dives is recommended.
- (iii) Due to the low ceiling and possible heavy silt a maximum of 2 divers per team in S section.
- (iv) Entry to the S section is via a tight restriction

Group 5 dives

Progression to group 6 dives by can be achieved by successfully completing either:

Method 1) 10 Tank Cave dives done in areas previously dived, including dives that require a number of jumps, shortcuts and alternative routes.

OR

Method 2) 15 dives done in sites equivalent to Tank Cave. Such dives must include jumps, alternate routes and traverses. These will be assessed on a case by case basis and once established can be used towards completing this group. You cannot include any dives previously listed in the Tank Cave Application Form.

Group 6 dives

Some of the distant areas of Tank Cave require the use of stage tanks. Before using stage tanks in Tank Cave divers must be proficient in such techniques and must provide logged evidence of at least 5 stage dives. **In addition to these five dives the first 3 stage dives in Tank Cave** must be done on dives in which the stage tanks are not used (except in an emergency) nor counted in air calculations.

These include:

- H tunnel
- H - F Circuit (jumps at B14, H1, A24, F2, B12)
- H tunnel side (jumps at B14, H2, A62)

SPECIAL SITE INFORMATION BULLETIN

• NUMBER 6 •

5L158 – THE SHAFT

This is the sixth in a series of Special Site Information Bulletins which have been prepared for the education and interest of Cave Divers Association of Australia (CDAA) members and the general public. It highlights special values and/or considerations felt to be of importance at cave diving sites.

Introduction

The Shaft was a very popular diving hole during the late 1960's and early 1970's, before it was closed in 1973 after four interstate divers died there under very dramatic circumstances. The resultant public outcry was the major reason for the formation of the CDAA, which sought to self-regulate cave diving before the Government banned it. Sporadic unofficial and official attempts at renewing access occurred during the next decade however all formal negotiations broke down in the early 1980's.

In late 1983, with the successful completion of the first CDAA Research Group project in Kilsbys Hole, it was felt that this report, plus an offer to produce photos and models of The Shaft, might help with renewed access negotiations. After some very lengthy and complex negotiations the mapping project was finally approved and it was completed successfully in 1984.

At the completion of the project, a number of the divers were on good terms with the owners, and were subsequently invited to bring others onto the property to dive The Shaft. These "guides" agreed to form a group to organise schedules and set diving standards so that all qualified CDAA members could visit the site.

The CDAA was first invited to include The

Shaft on its formal access list in 1989, and the volunteer guides ran expenses-only trips to Mount Gambier on a fairly regular basis. The first Site Access/Landowner Liaison Committee was also formed around this time, with major efforts commencing to formalise and legally protect everyone involved in such guided access arrangements.

In 1998, the need for public indemnity insurance increased and it became necessary for the CDAA to ensure that its activities at supervised sites were in line with industry standards.

Cave Diving Supervisors

The Shaft is a supervised dive site and as such diving can only take place on scheduled times and under the leadership of a CDAA cave diving supervisor. Scheduled times and Shaft cave diving supervisors are specified in Guidelines. The presence of cave diving supervisors, on site during dives, is a requirement of the landowner. They will ensure that divers enter and exit the property in a safe and organised manner, that dives are conducted safely and they are responsible for ensuring that CDAA rules as well as the landowners requirements are adhered to. Cave diving supervisors will coordinate and facilitate entry and exit to the water however it remains the divers responsibility to get in

ATTACH 2
PHOTOS
HERE

CAVE DIVERS ASSOCIATION OF AUSTRALIA

(INCORPORATED IN SOUTH AUSTRALIA)
P.O. BOX 290, NORTH ADELAIDE, S.A. 5006

C.D.A.A
NUMBER

Membership Application Form

Applicant's Personal Details

Surname: _____

Given Names: _____

Address: _____

Postcode: _____

Phone: (h) (_____) _____ Date of Birth: _____ Sex: _____

(w) (_____) _____

In consideration of me being accepted as a members of the Cave Divers Association of Australia Inc., I agree to indemnify the Association and any other officer, employee, instructor, or guide of the Association, or any other person organizing, controlling, or assisting with a function, event, dive, expedition, training, testing, or administrative task or obligation, associated with the Association, from and against all claims, costs, demands and lawsuits that I have or may, have for personal injury or property loss, whenever occurring, against the Association or any of those people, arising out of or in relation to any function, event, dive, expedition, training, testing, or administrative task or obligation, associated with the Association or with the sport of Cave Diving.

I have read and understand the aims and objectives of the CDAA and am in support thereof.
I hereby apply for membership.

Signed: _____

I enclose \$50 being CDAA membership for 1999/2000 and an additional \$50 for each additional membership year.

☐ I enclose my cheque / money order

☐ Please charge to my credit card

BANKCARD

☐

VISA

☐

MASTERCARD

☐

Credit Card No.

--	--	--	--	--	--	--	--	--	--	--	--	--	--	--	--	--	--	--	--

Expiry Date: _____ Signature: _____

SHAFT DIVING APPLICATION FORM

(Please forward to the Shaft Access Manager)

(Refer to Special Site Access Bulletin No. 6, Guidelines Issue 69)

Diver's Name:

CDAA Membership Number: Contact Number:

Divers applying to dive The Shaft for the first time must meet the following pre-requisites:

- Hold the CDAA rating of Sinkhole.
- Provide evidence of a minimum of 20 dives to at least 30 metres, 10 of which must be in CDAA sanctioned sites with at least 5 of these whilst wearing twin tanks.
- Be able to climb a 10 metre free hanging wire ladder.
- Be in possession of an appropriate harness and suitably rated karabiner and tape for lowering tanks.
- Sign the appropriate indemnity form.
- Read, understand and agree to comply with the provisions of Special Site Access Bulletin 7.

Please detail your last twenty dives as specified above, indicating twin tank dives with an “*”.

<i>Date</i>	<i>Location</i>	<i>Depth</i>	<i>Bottom Time</i>	<i>Buddy</i>

I (full name of diver)

declare that, to the best of my knowledge, the above is true.

Signed this day of,

MEMBERSHIP RENEWAL

- (1) Please fill out the Membership Application Form on the other side
- (2) Include 2 x Photographs passport quality.
- (3) CDAA number.
- (4) Enclose your cheque for \$50 per year PAID.
- (5) Enclose a stamped self-addressed envelope.

**AFTER AUGUST 31ST ANY UNPAID
RENEWALS WILL INCUR A \$50 LATE FEE**

NITROX ENDORSEMENT

Anyone wishing to add a Nitrox Endorsement will need to include a photocopy of their certification and pay a once only processing fee of \$10.

and out of the site. Hence good climbing skills are required. Divers unable to climb a wire ladder must contact the Shaft Access Manager, or the cave diving supervisor so that alternative arrangements can be made.

Cave diving supervisors have the full support of the National Committee and their directions must be followed at all times. They have the authority to deny access in the event of:

- Inappropriate diving equipment configuration or poorly maintained diving equipment.
- Inappropriate attitude or behaviour.
- Failure to follow directions.

Diving in The Shaft is not possible without the efforts of cave diving supervisors who give up their time so that members can enjoy pleasurable dives. It is unlikely that cave diving supervisors enjoy relaxed dives on CDAA scheduled times. In recognition of this, provision has been made to enable cave diving supervisors to seek approval to undertake dives additional to those scheduled. Such a request must include the names of all divers and approval is subject to:

- CDAA scheduled access not being compromised.
- Clearance by the Shaft Access Manager.
- Diving being conducted within the rules and regulations of the CDAA

The Application

Divers wishing to dive The Shaft for the first time must meet the following pre-requisites:

- Hold the CDAA rating of Sinkhole.
- Provide evidence of a minimum of 20 dives to at least 30 metres, 10 of which must be in CDAA sanctioned sites with at least 5 of

these using CDAA-sanctioned twin tank systems.

- Be able to climb a 10 metre free hanging wire ladder.
- Be in possession of an appropriate and correctly configured harness as well as a suitably rated karabiner and tape for lowering tanks.
- Complete the Shaft Diving Application Form and forward to the Shaft Access Manager.
- Sign the appropriate indemnity form.
- Read, understood and agree to comply with the provisions of this Special Site Access Bulletin.

The Shaft Access Manager will advise you when your application has been processed. From here the process is the same as for returning divers.

Returning Divers

In order to book a dive in the Shaft you must contact the Shaft Access Manager, by phone or mail, a minimum of two weeks prior to your intended booking. A fee per diver per day applies to Shaft dives, it is currently \$15 but may be amended from time to time by notification in Guidelines or the CDAA's Regulations. This fee will help offset the cave diving supervisor's travel, accommodation and incidental costs, (incidental costs includes lost, misplaced or damaged equipment) and will be collected by the cave diving supervisor on the day of your dive.

Divers who book to dive and fail to show up or divers who fail to pay following their dives will not be booked into future Shaft dives or any dives where the booking arrangements are managed by the CDAA. Divers in this situation will not be allowed to renew their membership until they have

discharged any encumbrance. Remember the cave diving supervisors are there for your benefit.

General Diving Information

- Divers must use twin tanks in an accepted configuration.
- Nitrox as a diving mix is not allowed.
- Decompression mixes attached to a shotline in accordance with CDAA rules are allowed.
- The maximum depth is 40 metres.
- Generally one but no more than two dives per day will be conducted. This will vary with the cave diving supervisor and or the particular circumstances of the group.
- Divers must conduct themselves so as to ensure exit of the property no later than 6 pm.
- Non CDAA members cannot enter the property.
- The maximum ratio of divers to cave diving supervisors is 6. The maximum number of divers diving at the one time is twelve.
- Access is granted at the landowner's discretion and convenience, so it may be possible from time to time that access may be cancelled on short notice.
- Mapping, research, exploration, fixed line placement and installation of reference aids must be coordinated through the Site Access Director.

The Dive

On the day of the dive you will meet the cave diving supervisor at the time and place specified when your booking was confirmed. First time divers will be required to sign an indemnity form and pay a nominal lease fee

of \$1.00. In addition first time divers will be required to sign the Shaft Visitors Log, maintained by the Ashby family since the early seventies. Following this you will be asked for the diving fee and then given instructions by the cave diving supervisor in relation to moving on and off the property.

Cars entering and leaving the property are only permitted to drive in and out once per day. Car access is at the discretion of the landowner and permission must be obtained prior to entering the property each day. Normally three cars will be allowed to enter the property on any given day but this may vary depending on factors such as rain and irrigation. There have been instances when cars have not been allowed to enter the property and divers have carried their equipment across the paddock.

Once on site you will be expected to assemble your diving gear and then the cave diving supervisor will brief you on all aspects of the dive. The type of dive undertaken is at the discretion of the cave diving supervisor and will generally be subject to the circumstances on the day including the size and experience of the group. First time divers will be accompanied by a cave diving supervisor and will undertake their first dive from the rockpile to sawtooth rock or in this general vicinity, (where the floor depth does not exceed 45 metres). This dive will help divers orient themselves with the cave.

After your diving is complete please follow instructions and exit the property in an orderly and timely manner.

NOTICE OF

1999 Annual General Meeting, Election of Office Bearers and Voting For Member Motions & Constitutional Amendments

This notice is issued pursuant to Clause 32 of the Constitution and serves to advise members that the Annual General Meeting of the Cave Divers Association of Australia will be held on 23 October, 1999 at the International Motel. The Annual General Meeting will commence at 10.00am and will conclude no later than 12.30pm

This notice also serves to call for:

- Nominations for office bearer positions;
- Member motions;
- Amendments to the Constitution.

The items so called must be received by the Returning Officer no later than the close of business Wednesday 1 September, 1999.

Items received after this date will not be accepted nor will any extensions to this date be granted.

Members intending to nominate for an Officer Bearer position must be an eligible member of the Association as defined in the Constitution. Nominations must be accompanied by a precis not exceeding one hundred words detailing skills, experience and achievements relevant to the duties and responsibilities of the nominated position. The responsibilities of Office Bearers are contained in the Constitution of the Association and additional responsibilities are detailed in the 1998/99 budget contained in this issue of Guidelines. Nominations must be in writing and be signed by the nominee, the proposer and the seconder, all of whom must be eligible members of the Association. The polling date for the election is 16 October, 1999.

The constitutional amendments carried at the 1998 Annual General meeting and reported in issue #67, (December 1998) of Guidelines, provide for two year terms for National Director, Site Access Director and the Publications and Records Director starting from the 1999 Annual General Meeting. Nominations for Business Director and Standards Director will be for one year terms, (Section 26(2)). Nominations in the year 2000 will be for Business Director and Standards Director only, and will then be effective for two years, (Section 26(3), 26(4)). Those members wishing to nominate for a position should make themselves familiar with these transitional provisions.

The election of Office Bearers and voting on amendments to the Constitution will be conducted entirely by postal ballot.

Polling date is 16 October, 1999. If you wish to vote you must be an eligible member of Association. you must use the ballot papers to be provided in the next issue of Guidelines or by special mailout, and you must ensure the ballot papers reach the Returning Officer no later than close of business, Friday 15 October, 1999. Detailed voting information will be provided with the ballot papers.

Questions may be directed to:

The Returning Officer, Mr Jim Ferry, 12 Grand Central Avenue, Hallett Cove, SA 5158
Mobile: 0417 862 351

Letter of Thanks

I would like to take this opportunity to acknowledge and thank several CDAA members for their hard work over the past years.

Sabine Schnittger held the position of Publications and Records Director from late 1997 until April 1999. She worked tirelessly too on many aspects of CDAA business, most notably Guidelines, new items of CDAA merchandise and public indemnity insurance with its associated legal and administrative implications. She is at present in Mexico, on the Yucatan Peninsula, taking part in on-going cave diving exploration and surveying work. We wish her all the best for the future, and hope to see her in Australia again some time soon!

Tony Davis has been involved in several aspects of CDAA fund raising, particularly in the area advertising in Guidelines. He has also organised the auxiliary activities to the Annual General Meetings such as the CDAA workshops, and Equipment markets in 1997 and the visit and subsequent talks by Lamar Hires, (of Dive Rite), in 1998. He has also taken much of the responsibility for organising the Members dinner and BBQ at the AGM. Thank you Tony for these efforts, they are much appreciated.

John Simpson is a Melbourne based lawyer and CDAA member who has, over the past eighteen months or so, provided free of charge, legal services in the areas of CDAA insurance and site access. This extremely generous contribution has saved the CDAA significant amounts of money, and resulted in a more comprehensive and reliable insurance policy. John will continue to offer his services to the CDAA as the need arises. Many Thanks John.

The efforts of people such as those above serve as a timely reminder that the CDAA currently relies almost solely on volunteers from within the organisation for its existence. I strongly urge you to consider what you might be able to contribute, either in the form of an ongoing position, or on a casual project basis.

Please feel free to contact one of the Directors listed at the front of Guidelines if you would like to discuss the matter further.

Regards,
Andrew Seifried

The following article was posted on a variety of email sites recently.

UNDERWATER CAVE RESCUE

Henry Nicholson
UCRR Team Program Co-ordinator

Subject:	Underwater Cave Rescue
Where:	Thunder Hole Cave, Madison County, Florida
Date:	June 24, 1999
By Whom:	International Cave Rescue/Recovery Team
Region:	Florida
Regional Co-ordinator:	Lamar Hires
Total Time Victim Submerged:	Five hours and fifty minutes
Type Dive:	Stage Dive
You read it right:	A Rescue NOT a Recovery

Summary of Incident:

On this date, two divers entered Thunder Hole Cave with stage bottles, with the intention of a penetration into the cave system. Shortly after entry into the cave, visibility was lost and the two divers became separated. The male diver searched for his female partner but failed to locate her after a reasonable attempt. He decided to immediately exit the cave and call for help.

The Florida Regional IUCRR Team, headed by Lamar Hires, was dispatched to the scene. The team immediately set up search patterns. The victim had been unaccounted for for an excess of five hours. It had all the indications of being a recovery and not a rescue.

Penetrating into the cave system revealed zero visibility at the entrance area. Clear water with undisturbed visibility was found after further penetration. The team concluded that the victim must be somewhere near the entrance in zero visibility. The search was concentrated in this area. Lamar Hires stated that while he was probing through the silt he heard a banging noise on a scuba tank. Investigating, he found the victim still alive in approximately thirty feet of water and escorted her safely to the surface. She had been underwater for five hours and fifty minutes.

This is an excellent example of a job well done. Thanks to the Florida IUCRR Team. By their quick response and immediate organised team action at the scene, a life was saved.

Again, Good Job!! Thank You!!

Dive in for some Mount Gambier Freshwater Video Action

Mount Gambier, in the South East of South Australia, has long been regarded as the capital of inland freshwater cave and sinkhole diving in Australia. Legendary clarity and depth combined with convenient access and year round diving ensured the Mount became part of the itinerary of divers from all over Australia, and with film crews from overseas. This popularity has not diminished and being only about 5 hours drive from Melbourne or Adelaide means that weekend dive expeditions are possible. In the early days of cave diving, the region became infamous for numerous diving tragedies which befell the pioneering generation of freshwater divers. Inexperience, lack of training, incorrect equipment, and disregard of basic safety rules, combined to give cave diving a sinister public reputation. Diving at the Mount was considered to be nearly as suicidal as swimming in the sea with all those sharks, despite the horrific road toll which hasn't really improved. There is something macabre in reporting about divers being lost in a tight, silty, water-filled cave and running out of air!

Fortunately, diving at the Mount these days has changed dramatically and the average diver can now safely dive the "death holes" of the past and really enjoy the experience. The Cave Divers Association of Australia was formed in 1973 to regulate the sport of cave diving. Standards and training were established as well as surveying of sites and categorisation according to hazards. Modern equipment and techniques have also given the edge to a new generation of cave divers. High pressure steel tanks coupled with high performance regulators, dry suits, BC wings, guideline reels, direction arrows, high wattage rechargeable quartz lamps and diving computers combined with redundant systems and use of the 1/3 air rule are the new safety standards which are in use.

Up until now the secret world of cave diving had only been occasionally revealed through snippets

of film from intrepid documentary makers like Australia's Ron and Valerie Taylor.

Capturing the modern thrill of cave and sinkhole diving at Mount Gambier, noted South Australian underwater photographer, Alex Wyschnja has produced a spectacular 45 minute infotainment VHS video titled **"Down Deep Down Under"** featuring most of the popular diving spots. From gigantic crystal clear sinkholes like the Shaft and Kilsbys with stunning displays of light beams to tight, silty tunnels in Pines and Engelbrechts, Alex has managed to capture the essence of diving at the Mount. In five years of living and diving there he has recorded many subtle and interesting aspects of the sites including the rarely seen water rat in Ewen's Ponds, eels, fish life and delicate plants in Piccaninnie Ponds and an ancient human skeleton he found in 1996. The video emphasises the things to be seen and experienced while diving in this freshwater wonderland without being overly descriptive about techniques and equipment. The freshwater aquifer levels have dropped dramatically in the last three years due to irrigation, and this video is already a record of what it was like in the good old days! The original Hi 8 footage has been professionally edited by Project Digital in Adelaide and combines a relaxing sound track with brief descriptive narration. It makes great viewing for any diver interested in freshwater and cave diving and is also a great reference for those who have already experienced Mount Gambier underwater.

Alex and the team at Project Digital sincerely thank the City of Mount Gambier and Sea Optics Australia Pty Ltd for their generous support in producing the video. RRP is \$29.95 and copies can be obtained from:

Project Digital

PO Box 215, Glen Osmond S.A. 5064

www.south-oz.net



C.D.A.A. Penetration Course

The next CDAA Penetration course is scheduled to run over consecutive weekends in October 1999.

The dates are:

Weekend 1 – October 2nd, 3rd and 4th

Weekend 2 – October 9th and 10th

The course will be run entirely in Mt Gambier.

Anyone who is interested, or would like more information, should contact the Course Co-ordinator Greg Bulling on: (08) 8265 4978 (ah) OR email: gbulling@dove.mtx.net.au

AGM DINNER

to be held at the

International Motel
Millicent Road, Mount Gambier

Saturday Evening 23rd October, 1999

*Cost: \$30 per head
includes a 3 Course Meal*

Payment to be sent to PO Box 290 North Adelaide 5006

NOTICE • NOTICE • NOTICE • NOTICE

MEMBERSHIP FEE DEADLINE

Section 13(3) 13(4) of the Constitution (as amended) September 1997, requires that membership fees are due 1st July of any membership year. Any member who has not paid by 1st September is deemed to be unfinancial. A \$50 late fee as specified in Schedule 2 of the regulations is payable in addition to membership fee in order to regain membership.

Remember that in order to nominate a Director, second a nomination or vote in the postal ballot, you must be a financial member of the Association (Section 9(2), 9(6), S13 (1) Constitution).

ANY MEMBERSHIP RENEWALS THAT ARE RECEIVED BY THE TREASURER AFTER CLOSE OF BUSINESS WEDNESDAY 1ST SEPTEMBER 1999 WILL ATTRACT A LATE FEE. THERE WILL BE NO EXCEPTIONS.

If you have not already renewed. DO IT NOW!

MOUNT GAMBIER

The Barn Motel

★★★★ RAA

Set on 12 acres – Quiet Location

- Central to Piccaninnie & Ewen Ponds
- Light breakfast included in moderate tariff
- Special rates for small group bookings
- Next door to Barn Steak House
- Undercover BBQ area, kitchen facilities
- Storage shed available

*The perfect place to spend
your holiday*

Ph: (08) 8726 8366

Fax: (08) 8726 8333

NELSON ROAD, MOUNT GAMBIER

NOTICE

An exciting new opportunity has been realised for members and potential members in the Northern Territory. After reviewing a detailed submission from David Cowan the CDAA directorate has agreed that:

1. both Berry Springs Nature Park and Rum Jungle Lake be accepted as CDAA sanctioned training sites,
2. Rum Jungle Lake be accepted as a CDAA sanctioned sinkhole site, and
3. at Rum Jungle Lake, a limit of 5 dives be placed on the prerequisite dives for the CDAA Cave Diver qualification due to tropical nature and lack of overhangs.

The directorate looks forward to reviewing further proposals from the Northern Territory to expand both training and sanctioned sites.

*Glen Harrison
Standards Director*

WANTED



ARTICLES FOR GUIDELINES

**IF SIGHTED PLEASE SEND IMMEDIATELY,
TOGETHER WITH ANY PICTURES TO:**

**The Editor, Glenn O'Connell
P.O. Box 290, North Adelaide, S.A. 5006.**

REWARD

An even better Guidelines for everyone.

CDAA SITE ACCESS

Remember: Access is a privilege, not a right. Please be considerate of landowners wishes.

CN = CAVERN S = SINKHOLE C = CAVE P = PENETRATION

SITE	LEVEL	OWNER	ACCESS DETAILS
MOUNT GAMBIER - SOUTH AUSTRALIA			
Ewens Ponds	Nil	DENR P.O. Box 1046 Mt Gambier 5290 (08) 8735 1177	Groups of 6 or more, phone/mail to Dept. of Environment & Natural Resources (DENR). Smaller groups, no need. Indemnity form to be completed.
Horse & Cart Tea Tree	CN CN	Peter Cunningham PO Box 643, Mt Gambier 5290	By phone or mail, 1 week prior. Ph: (08) 8738 4003.
Little Blue	S	Port MacDonnell	Little Blue - permission not required - must carry card.
Allendale	C	Port MacDonnell	Obtain key from Mt. Gambier Tourist Information Centre.
Gouldens 2 Sisters Fossil	CN CN C	DENR P.O. Box 1046 Mt Gambier 5290 Ph: (08) 8735 1177	General Diving: Divers to contact DENR and notify of date and site to be dived. Divers must have the correct CDAA diving endorsement for the site. The onus of proof of CDAA status is on the diver and is provided by presentation of CDAA membership card or DENR checking the membership list supplied by CDAA. If there are problems with the diver not being a current financial member DENR will not be chasing the records officer to sort out the problem. This will be the responsibility of the diver. The diver must have signed an indemnity with DENR before access is permitted. Training: Cavern and Sinkhole. The Instructor is to notify DENR of the date the sites are needed and to forward signed indemnities from each student and their temporary card number. Cave and Penetration: The Instructor is to notify DENR of the date the sites are needed and is required to forward signed indemnities from each student and their membership number.
Ela Elap One Tree	S S	Mr. Peter Norman Private Bag 67, Mt Gambier 5290	By phone or drop in before diving. Ph: (08) 8738 5287
Swim Through	C	Valerie Earl PO Allendale 5291	Currently CLOSED pending new access arrangements.
Piccaninnie Ponds	S	DENR P.O. Box 1046, Mt Gambier 5290	Permit holders by phone. Be aware of delicate vegetation. Indemnity form to be completed. Ph: (08) 8735 1177 Faxed copies of cards no longer accepted when booking.
Hells Hole Pines Mud Hole	S P/C C	Primary Industries S.A. (Forestry) PO Box 162 Mt Gambier 5290	Contact Primary Industries S.A. (Forestry) by mail, phone or fax to arrange permit. Collect permit from Regional Office, Jubilee Hwy., Mount Gambier. No diving on total fire ban days. Forest Work Bans may be applied by PISA Forestry if forest fire danger is expected to reach extreme. Such bans also exclude the public from entering the forest. If in doubt, please check with Trevor Wynniat, although signs are generally erected at diving sites on such days to indicate such bans. Permits will ONLY be issued Mon-Fri between 8.30am-4.30pm. Ph: (08) 8724 2876 Please use this number for all bookings and enquiries etc. Fax: (08) 8724 2885 Email: wynniat.trevor@pi.sa.gov.au. Written confirmation required.
Kilsby's	S	Landowner leased to S.A. Police	Restricted access conditions apply - refer Guidelines Issue 54. Twin tanks, maximum of 40 metres depth. Write to: RSD 2232, Portland 3305, 4 to 6 weeks prior to wanting to dive. Please enclose stamped self-addressed envelope. Aug 7/8, Sept 5/6, Oct 2/3, Nov 6/7, Dec 4/5. No animals permitted.
Shaft	S	Generally open one weekend a month L. Claridge P.O. Box 290 North Adelaide 5006	TIMETABLE FOR "THE SHAFT" GUIDES For access dates contact Linda Claridge. Also, see Special Access Bulletin in this issue. Nitrox as a diving mix is not allowed in the shaft. Deco mixes ATTACHED to a shot line are permissible. Divers applying to dive in the Shaft must have documented experience of a least 5 twin-tank dives.
Ten Eighty Bullock Hole Black Hole	S S S	Mr. Colin Traeger PO Box 12, Mt Gambier 5290 (087) 26 6215	Sundays only Mail Booking Form to Colin Traeger 2-6 weeks prior, stating names/qual. of all divers, and time slot. Please include stamped self addressed envelope. Closed October to November for shearing.

CDAA SITE ACCESS

SITE	LEVEL	OWNER	ACCESS DETAILS
MOUNT GAMBIER - SOUTH AUSTRALIA (continued)			
Max's Hole	C		Phone or mail 1 week prior to dive. Ph: (08) 8726 8277 Currently closed pending access arrangements with new owner.
Hann's cave	P	P & A Lasslett	Groups of four divers only apply in writing to Site Director. Limited groups will be allowed access over the summer months. The site is very delicate and therefore only limited access is available. Divers applying will be notified as to further access details. Please include a stamped self addressed envelope.
Engelbrechts - East - West	C P	Mt Gambier Council	Obtain key from Mt Gambier Tourist Information Centre. Access agreement must be signed prior to diving. Key must be returned by 5pm Sunday, 2 divers must sign out keys, all divers must sign in advising which groups they are diving with.
Three Sisters	P	Millicent Council	Contact Linda Claridge (Records' Officer). Access available for experienced Penetration divers only. Low profile or side mounted independent air systems required. Access agreement must be signed prior to diving. Please allow 4 weeks for indemnities to be processed.
Idlebiddy (5L250) Nettle-Bed (5L290)	P P	Primary Industries S.A. (Forestry) PO Box 162 Mt Gambier 5290	5L250 open 1st & 3rd weekend of every month. 5L290 open every weekend. Max. 4 divers per dive per day, 1 dive per day for each site. Only Penetration divers completed practical in-water cross-over. Bookings from Forestry Office - key from Lady Nelson. Contact Primary Industries SA (Forestry) by mail, phone or fax to arrange permit. Collect permit from Regional Office, Jubilee Hwy., Mt. Gambier. No diving on total fire ban days. Forest Work Bans may be applied by PISA Forestry if forest fire danger is expected to reach extreme. Such bans also exclude the public from entering the forest. If in doubt, please check with Trevor Wynniat or Forestry Office, although signs are generally erected at diving sites on such days to indicate such bans. Permits will ONLY be issued Mon-Fri between 8.30am-4.30pm. Ph: (08) 8724 2887. Please use this number for all bookings and enquiries etc. Fax: (08) 8724 2885 Email: wynniat.trevor@pi.sa.gov.au. Written confirmation required.
McKay's Shaft	S		Contact Phil Argy at Mt. Gambier as access can be arranged.
Tank Cave	P	Mr. DYCE	Tank Cave Access Manager: Jim Ferry Ph: 0417 862 351. For access details see Special Bulletin No. 7 in this issue of Guidelines.
Baker's Cave	C		Please write to the Site Access Director to dive in Baker's Cave. Include stamped self-addressed envelope. Climbing equipment required.
NULLARBOR - WESTERN AUSTRALIA			
Cocklebiddy Murra El Elevyn Tommy Grahams	C P/C C	Regional Manager C.A.L.M. 120 Albury Highway Albany 6330	Apply in writing for permission to dive at least 4 weeks in advance of trip to: John Watson, Regional Manager C.A.L.M., 120 Albany Hwy, Albany, W.A. 6330. Phone: (08) 9841 7133
Weebubbie	C		Apply in writing with at least 4 weeks notice to: Graham Higgins, Dept. of Land Administration, PO Box 2222, Midland, W.A. 6056. Include in the application: • The dates of the intended visit(s) • Photocopies of CDAA certification cards for all of the party • A signed Indemnity Form for Weebubbie Cave (photocopy from original in Issue 61 of Guidelines). Please note that this arrangement is for Weebubbie only and access to other caves on the Nullarbor must follow existing access protocol. Also note that divers must supply their own ladders as the old ladder has been removed.
WELLINGTON CAVES - N.S.W.			
Limekiln (McCavity)	P/C		Both Penetration and Cave Level are being accepted for this cave depending on it's water level at the time. The cave has a restriction at the entrance which is underwater making it a Penetration Dive. During drought, the water level drops to form a small lake below the restriction allowing experienced Cave Divers access to this delicate cave.
Water (Anticline)	C		Affected by high CO ₂ levels during Summer/Autumn. Access arrangements are co-ordinated with an already commissioned research group. Contact Greg Ryan (02) 9351 4809 w, (02) 9743 4157 h, greg@cs.su.oz.au.
Rum Jungle Lake Berry Springs	S		No specific access arrangements.

TRADING POST

FOR SALE

Cave/tech diving light,
all marine anodised aluminium,
12v 15amp hour battery, 100w,
50w or 30 watt bulb, compact
head, switch on battery pack,
charger, as new \$600.

Neil Vincent (02) 971 798
email neilv@ozemail.com.au

FOR SALE CUSTOM-BUILT DIVE TRAILER

6 x 4 Trailer – Lift Up Hood style with:
Deadlocks on both sides for security; Built-
in partitioned storage for 6 tanks each end,
leaving space for heavy weight belts, etc in
the middle of trailer over axle;
Brand new floor; New professional paint
job; and Electrical brakes on trailer.

This trailer will comfortably take 4
people's dive gear to Nullabor or
would suit professional dive instructor.

\$1500

Call Glenn on 0411 704 758 or
(H) 03 9432 3489

FOR SALE

AS NEW with instruction manuals & all in
original boxes - used mainly in fresh water:

- Nikonos 4A
- SB101 Flash
- Pelican Case
- 15mm Lens (incl. view finder)
- Close Up Lens (outfit)
- 35mm Lens
- 28mm Lens
- Difuser

Further details

(08) 8336 1616

FOR SALE

Two 63 cubic ft
aluminium tanks, with
stainless steel bands.
\$320 the lot.

Phone Clive Wheeler
CDAА 2409
8298 5952

FOR SALE

1 x Diverite Neutralite with MR 16 head,
brand new batteries \$550

3 wings, backplate and harness sets good
condition \$350

2 x Cochran nemesis II Nitrox air integrated
2 mix computers \$800 each

2 x Cochran nemesis IIa Nitrox air
integrated 3 mix computers \$900 each

Stephen G Sturgeon 9527 7667

CDAА NOTICES

GUIDELINES DEADLINES

If you would like to contribute to
Guidelines, you should note the
following deadlines for
submission of materials:

Deadline	for publication
21st August	September
21st November	December

NOTICE FOR INSTRUCTORS

Procedure for ordering student packs:

1. Check you are insured & financial.
2. Send order & cheque or by phone/credit card.
3. Allow 14 days from when the order is received -
so allow plenty of time.
4. Student kits cannot be returned.
5. Instructors must be active.
6. Please do not pass my number on to dive shops -
you should deal with them not me.

• INSTRUCTOR RENEWALS •

Several instructors have not yet renewed their CDAА
ratings. Instructors must lodge their current insurance
details and renewal fee or packages will not be issued
and certifications rejected.

Instructor Renewals, PO Box 15, KOROIT 3282

Deb Williams
Instructor Materials Officer

ACTIVE CDAА INSTRUCTORS

Any Instructor wishing material contact - (03) 9543 3930 or email: deb@agentis.com.au

STANDARDS DIRECTOR:

Glen Harrison
Telephone: 0407 608 609
(email) harrison.glen@saugov.sa.gov.au

INSTRUCTOR	CN	S	C	STATE	PHONE	INSTRUCTOR	CN	S	C	STATE	PHONE
NSW & ACT						VICTORIA					
Nick Jones	.	.	.	ACT	015 851 313 m	Stephen Arnel	.	.	.	VIC	(055) 26 5230 h
Peter Grills	.	.	.	NSW	(02) 4950 6262 (8am - 12 midday)	Gary Barclay	.	.	.	VIC	(03) 5565 8793 h
Gary Norgard	.	.	.	NSW	(049) 68 4588 h	Jane Bowman	.	.	.	VIC	(03) 9579 2600 w
Andrew Robertson	.	.	.	NSW	018 412 563 m	Stan Bugg	.	.	.	VIC	(03) 9379 8791 h
Des Walters	.	.	.	NSW	(060) 411 405 w	Linda Claridge	.	.	.	VIC	(03) 5565 8793 H
Liz Butler	.	.	.	NSW	0409 463 176	Brian Cornell	.	.	.	VIC	(059) 85 2514 h
SOUTH AUSTRALIA						John Dalla - Zuanna	.	.	.	VIC	015 887 060 m
Greg Bulling	.	.	.	SA	014 477 430 m (08) 8265 4978 h	Chris Edwards	.	.	.	VIC	(03) 9579 4352 h
Glen Harrison	.	.	.	SA	0407 608 609 m (08) 8386 3237 h	Barry Heard	.	.	.	VIC	(056) 27 6474 h 019 401 469 m
John Hanson	.	.	.	SA	(08) 8269 1083	Ian Lewis	.	.	.	VIC	015 284 051 m
Max Marriot	.	.	.	SA	(08) 8447 3360 h	Warrick McDonald	.	.	.	VIC	(03) 9579 2600 w
Richard Megaw	.	.	.	SA	(08) 8344 1733 h	Bob Wealthy	.	.	.	VIC	(056) 858 338 h
Richard McDonald	.	.	.	SA	(08) 8295 4140 h/w	Frank Zeigler	.	.	.	VIC	(055) 236 392
WESTERN AUSTRALIA											
Gary Bush	.	.	.	WA	0417 957 620 m						
Marilyn Boydell	.	.	.	WA	(08) 9349 5646 h						
Steve Sturgeon	.	.	.	WA	(08) 9527 7667 h/w 0418 940 143 m						

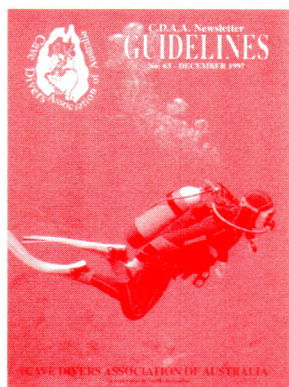

C.D.A.A. Newsletter
GUIDELINES
No. 66 - MARCH 1991

THE CANADIAN DIVERS ASSOCIATION OF AUSTRALIA
P.O. BOX 20000
MELBOURNE VIC 3001
TEL: 03 9581 1111
FAX: 03 9581 1112

AUG 1999

Cardholders Name: _____	Sub Total \$ _____
Address: _____ _____ Postcode: _____	Plus postage & handling \$6.00
	TOTAL \$ _____
Card No. <table border="1" style="display: inline-table; width: 150px; height: 20px; vertical-align: middle;"></table>	<input type="checkbox"/> Bankcard <input type="checkbox"/> Mastercard <input type="checkbox"/> Visa
Expiry Date: _____ Signature: _____ Ph: () _____ Fax: () _____	



INTERNATIONAL MOTEL



Mount Gambier

"The Cave Divers home away from home"

Our Facilities Include:

- * 60 Ground Floor Units - Modern & Spacious
- * Licensed Restaurant - Extensive Dinner Menu
- * Huge indoor heated pool, spa & sauna
- * Austar multi channel pay TV free to all rooms
- * Secure floodlit off street parking
- * Quality Flag Accommodation
- * Late Check In available

SPECIAL DISCOUNTS TO CDAA MEMBERS

(Excluding Easter Weekend)

ROOMS FROM \$50 !!

**RING TOLL FREE ON 1800 088877
TO MAKE YOUR RESERVATION**

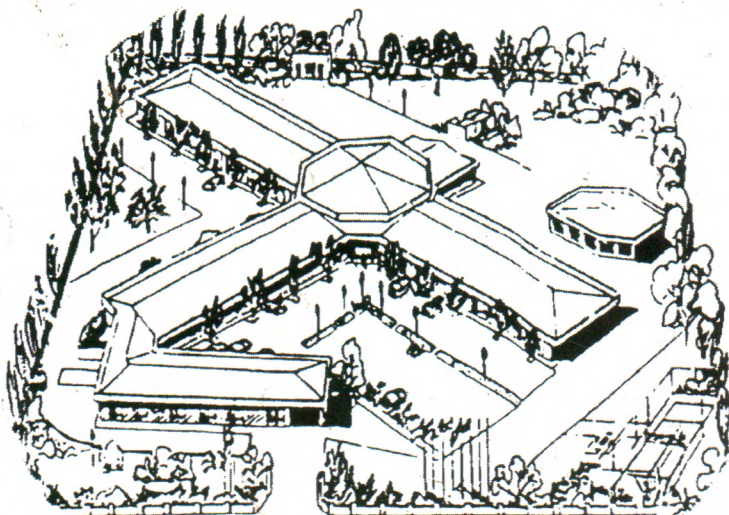

**OFFICIAL
CDAA
CORPORATE
SPONSOR**

**MT GAMBIER
INTERNATIONAL MOTEL
MILLICENT ROAD, MOUNT GAMBIER
TEL: 08 8725-9699 FAX: 08 8725-0843**

**OFFICIAL
CDAA
CORPORATE
SPONSOR**