

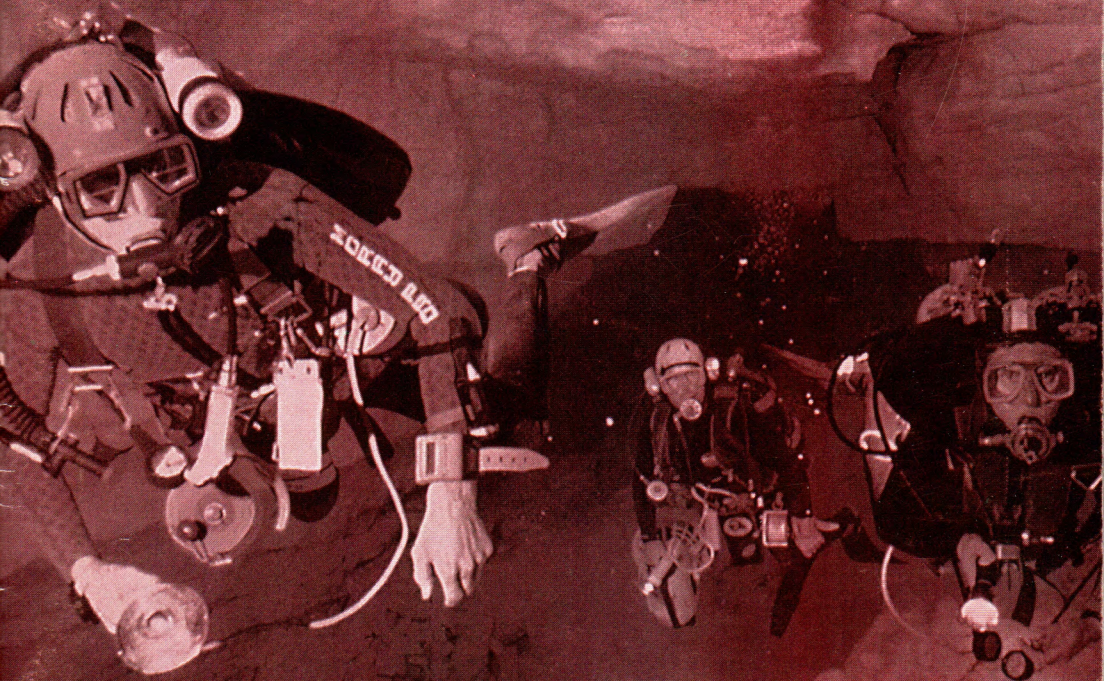

C.D.A.A. Newsletter GUIDELINES

No: 70 - DECEMBER 1999



CAVE DIVERS ASSOCIATION OF AUSTRALIA

(Incorporated in South Australia)

Print Post No. PP 381691/00020

At Zeagle we think of our equipment as a system, custom tailored to make your diving safer and more enjoyable.

Shoulder system can be selected for size, D-ring configuration and style.

Zeagle regulators offer the highest performance in a range of configurations suitable for every diving environment.

Zeagle Status II dual mix nitrox computer enables up to 100% oxygen for deco stops and many user adjustable options for individual setup.



Bladder assemblies can be selected for style, material and amount of buoyancy.

Vest section of the BC incorporates a weighting system and can be selected for sizing, attachment style and whether single or dual tanks will be used.

Waist closures have a wide range of adjustment and come in a variety of closure configurations.

PFS

The Personal Fit System

All Zeagle buoyancy systems are constructed from modular interchangeable components. This makes it easy to custom fit each and every system to the diver. Torso length is sized by changing the shoulder section; waist size by selecting the proper vest style and size. Further adjustments are provided by multi position elastic waist panels. Component styles can be mixed as well - some BC models give the diver the option of different bladder styles and weight systems. Several models allow the diver to easily switch between single and twin cylinders. You and your Zeagle dealer can build a custom diving system perfectly tailored to your needs.

Proudly distributed in Australia by
Divers Supplies Pty Ltd
43 Hinkler Road, Braeside, Vic 3195
Phone (03) 9580 5666



Integrated Diving Systems

Editorial

This is the time of year we all look forward to a bit of time away from work and hopefully time to enjoy a bit of diving if we're lucky.

I would like to extend Christmas wishes to all and hope you have a safe and Happy New Year.

Glenn O'Connell
Editor

ARTICLES FOR GUIDELINES

Members wishing to submit articles for inclusion in guidelines can do so in the following manner:

- Send articles & photos via post to:
The Editor, Glenn O'Connell,
P.O. Box 290, North Adelaide, S.A. 5006.
- Email to glenn@vds.net.au
- Any files for inclusion should be saved in "TEXT" or "ASCII" format. Hardcopy should also be provided wherever possible.

ADVERTISING RATES

FOR SPACE - APPLY TO THE EDITOR

"Guidelines" magazine is circulated to over 1200 members and retail outlets.

Back Page	2 colour	\$350.00
Inside Front Page	Black & White	\$300.00
Inside Back Page	Black & White	\$300.00
Full Page	Black & White	\$250.00
Half Page	Black & White	\$150.00
Quarter Page	Black & White	\$100.00

CONTENTS

Editorial	3
Filthy First Timers - Nullabor 98	6-8
Privileged Access	10-11
Not Everyone's Idea of Fun	12-13
Recent Double Fatality	14-15
ForestrySA / CDAA Site Access Information	16
Letter from a Member	17
CDAA 1999 National Committee Annual Report	18-29
Tank Cave Diving Schedule 2000	30
CDAA Notices	32
CDAA Products	39

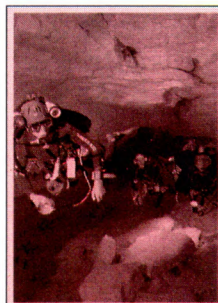

Front cover:

Weebubbe
June 1999

Photo by
Peter Rogers

CAVE DIVERS ASSOCIATION OF AUSTRALIA

P.O. BOX 290, NORTH ADELAIDE,
S.A. 5006

GUIDELINES is a newsletter of the Cave Divers Association of Australia. All articles for the following issue are to be sent to the Editor, Glenn O'Connell, P.O. Box 290, North Adelaide, S.A. 5006. All articles and submissions shall automatically constitute an expressed warranty by the contributor that the material is original. We assume no responsibility for unsolicited material. Articles and information may be reproduced without prior permission provided reprints are accredited to the authors and GUIDELINES. Private advertising for caving and diving equipment may be advertised free at the discretion of the Editor. Opinions expressed in GUIDELINES are those of the individual authors and are not necessarily those of the C.D.A.A.

CDAA DIRECTORY

The following is a list of people that can be contacted for CDAA matters. Please contact the most relevant person or, if unsure write to:

C.D.A.A. P.O. Box 290 NORTH ADELAIDE S.A. 5006

If you know who you want to write to, please address your letter to the relevant director.

NATIONAL DIRECTOR

Steve Sturgeon 0418 940 143 (mobile) (08) 9527 7667 (work)
P.O. Box 5233 Rockingham Beach (08) 9528 6995 (fax)
Western Australia 6168 Email: cdad@nitrox.com.au

MANAGER RESEARCH & MAPPING

Gary Barclay (03) 5565 8793 (home) (03) 5565 8118 (fax)
P.O. Box 15 Koroi Victoria 3282 garinda@tpgi.com.au

STANDARDS DIRECTOR

Glen Harrison 0407 608 609 (mobile)
24 Broadbeach Drive harrison.glen@sa.gov.au
Maslin Beach South Australia

Investigations Officer

Noel Dillon 0407 530 103 (mobile)
PO Box 112, Queenscliff, Vic. 3225

Instructor Materials

Deb Williams (03) 9543 3930
80 Manton Road, Clayton Victoria 3168 deb@agentis.com.au

Instructor Records

Linda Claridge (03) 5565 8793 (home) (03) 5565 8118 (fax)
PO Box 15, Koroi, Victoria 3282 garinda@tpgi.com.au

BUSINESS DIRECTOR

Carlo Virgili 0411 242 900
PO Box 1589, Adelaide 5001 carlovir@tafe.sa.edu.au

Treasurer

Andrew Seifried (08) 8379 4013 (home) seifried@senet.com.au

SITE DIRECTOR

Steve Amell (03) 5526 5230 (home)

2332 Holmes Road Portland 3305

PUBLICATIONS AND RECORDS DIRECTOR

Chris Edwards 0417 116 372 (mobile)
cedwards@teksupport.net.au

Records Officer

Linda Claridge (03) 5565 8793 (home) (03) 5565 8118 (fax)
PO Box 15, Koroi, Victoria 3282 garinda@tpgi.com.au

Editor

Glenn O'Connell 0411 704 758 (mobile) glenn@vds.net.au

CDAA products

Chris Edwards 0417 116 372 (mobile)
cedwards@teksupport.net.au

Phil Argy (08) 8723 0879 (home) blinkbonney@seol.net.au

CDAA Advertising

REPRESENTATIVES

Victoria

Warrick McDonald (03) 9579 2600 (work)

New South Wales

Andrew Robertson (02) 9525 0995 (home) 0414 412 563 (mobile)
buggs@tig.com.au

South-east (Emergency only)

Phil Argy (08) 8723 0879 (home) blinkbonney@seol.net.au

RETURNING OFFICER

Jim Ferry (08) 8381 1911 (home) jvcferry@bold.net.au
12 Grand Central Avenue Hallett Cove South Australia 5158

PUBLIC OFFICER

Kevin Burrows
11 Oakfield Avenue Clarence Park South Australia 5034

CDAA INSURANCE

Insurer: Jardine Underwriting Agency Pty Ltd
Policy number:
Coverage: \$10,000,000 public liability coverage
Expiry date: 11/7/99

As a recreational or technical diver your most important piece of equipment, your lifeline, is your regulator.

The Poseidon range of regulators has incorporated the highest performing technologies into unique designs, which ensure both your safety and your comfort regardless of your angle in the water.

In addition, these regulators have been tried and tested in all types of environments, whether it be warm or cold water and, at depths ranging from just beneath the surface to 282.6 meters.

The Jetstream The ultra-high performance regulator offering extreme breathability regardless of depth or work rate. In short, the standard by which all other regulators are judged.



The Cyklon 5000 The legend. "Top Class" rated. Specified by commercial divers. Popular with cave and technical divers alike. Used by many of the world's navies. The one which built Poseidon's reputation for reliability.



For many years, divers have selected Poseidon as their ultimate buddy. Make the only choice, make the safest decision and dive with Poseidon.

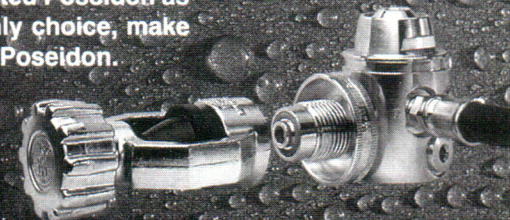

innovative [since 1958]

POSEIDON

DIVING SYSTEMS

Poseidon Diving Systems (Australia) - Tel: (02) 9904 8440 Fax: (02) 9904 8447
Website: www.poseidon.se

Design: Lateral Vision



FILTHY FIRST TIMERS – NULLARBOR 98

By Alex Wyscnja CDDA 2701

While Mount Gambier is known as the cave diving capital of Australia, diving beneath the remote Nullarbor plain has long been one of the Holy Grails for Australian cave divers. The area is only relatively new in terms of exploration with the first real exploration in the subterranean labyrinths commencing in the early 1970s. Recently the area became renowned when Adelaide cave diving guru, Chris Brown, set a world cave diving record by swimming to the end of Cocklebidy Cave, some 6km from the entrance. Previous expeditions by others had nearly reached the end, Chris pushed on for about 30 metres further, claiming the record.

After viewing about twenty southern right whales at the Head of Bight, seventeen enthusiastic cave divers assembled at Border Village on 28 June 1998, to undertake two weeks of Nullarbor narcosis. Rob Smith, Stewey Darke, Steve Watson, Chris Ross, Dave Blundell, Steve Trewavas, John McMillan and James Brown (ex USA) had driven from Melbourne, Phil Argy from his home base, Blink Bonney Lodge in Mount Gambier, Tim Foster, Heika Apps and Tony Dromgool from Canberra and Warren Reid, Chris Toomer, Jeff Smith, my wife Margy, our three kids Nick, Katie, Ben and myself from Adelaide. Only Phil, Chris T, Tony and Warren had dived the Nullarbor previously, the rest of us were first timers! Warren is a real veteran as this was his fourteenth trip out there.

The game plan was to head to Tommy Graham's cave which is situated south of Cocklebidy in Western Australia. The campsite in dense mallee scrub was soon buzzing with generators and three compressors. Enough diving gear was unloaded and strewn about the bush to fill a couple of dive shops. Tommy's is an easy site to dive, the real difficulty is getting your gear to the water. The water table lies some 90 metres below the limestone plain and the cave is almost completely collapsed in parts. It was on with helmets, lights and overalls and into the humid grovelly cave to manhandle multiple 100 cu ft tanks, lights, regs, suits, reels, wings and other cave diving paraphernalia through the tight crawlways, all the way down to the water's edge. This deal is definitely not for the faint hearted or unfit and I was glad that I had trained hard on the track prior to the trip. The water temperature in Tommy's is something of a shock compared to Mount Gambier, 22 degrees seemed almost like a warm bath and I was comfortable diving in a surfing steamer. We separated into different groups and explored various parts of the submerged wonderland. Crystal clear shallow water led us through a 50m long keyway which opened into a pretty flowstone drop-off into 27 metres, nicknamed the ski slope. Beneath the keyway was a sizeable chamber with different density water mixing giving a hallucinatory effect to the crystal blue water. The boys ended up calling this the Jimi Hendrix room, maybe the purple haze

really got to them! Some of the fitter members of the group climbed over the rockpile in full rig (twin 100cu ft tanks) to dive the second sump. For all intents and purposes the dry air chamber is a scuba zone as the CO2 levels are far too high for anything but a casual look. After a couple of dives and carrying the tanks to the surface for fills it was time to lump all the gear out of the cave and relocate it into Murra El Elevyn cave, 6km to the west of Cocklebidy.

John Mc Millan set up his home spun lifting and lowering frame and soon all the gear was lying at the cave entrance, ready to be carried over the rocks down to the water's edge. The initial drop, on the deep side of the doline, is something like 50 metres, some adventurers abseiled into the cave while others climbed the 6m fixed extension ladder kindly fixed to the shallow side of the cave by Chris and Jeff. Murra would have to have the best gearing up platform going, with a large flat slab of limestone in ankle deep water right next to the tunnel entrance. It seemed almost obscene to have it that good after the hell climb and walk into the cave. Murra was a real mind blowing cave dive, meandering passages, tight collapses, large rooms, air pockets and a fixed line with arrows to the end which is 300 metres from the entrance. James pushed an extra 35 metres of new cave in the low flat section wearing sidemounts but the line has been cut and separated as a jump to discourage any back mount divers from entering this extremely tight section of the cave. The cave is only shallow, less than 15 metres, so plenty of exploration can be done using twin 100s before 1/3 air is used and the cave diver turns for the entrance. I had a few flutters

on my first dive in the cave as I was with Phil, and not really concentrating on the layout, being too busy looking through the video camera viewfinder. Slight confusion on exit had me swimming along the fixed line into a side tunnel and up into an air chamber. Phil joined me for a spell in the air pocket which enabled us to cruise back and explore an alternative entrance to the main tunnel and fix a new temporary line complete with direction arrows. It was great to get all the gear out of the cave and enjoy a cold beer and warm freshwater shower at the Cocklebidy roadhouse complex.

Next it was on to the famous Cocklebidy Cave for a look and to set up the gear. Margy and I along with a few others opted not to dive here but just have a day off to relax. I believe this is the key to surviving a Nullarbor diving trip as the physical effort (especially for over 40's) is so punishing. The cave has an easy walk in entry and the kids were excited to see the huge dimensions of the lake chamber. A steady rain during the day made the clay access road to the cave very slippery. I had to engage 4wd in the Landcruiser while Phil and Rob snaked and slid their way across the greasy plain in a Commodore.

We broke camp next morning and headed 300 km east to Weebubbie Cave, just out of Eucla, while the others retrieved their gear after the long 1km swim to the rockpile in Cocklebidy Cave. We made camp just on dark and were surprised to meet up with a West Australian group of fellow cave divers. Paul Hosie and his companions Karl and Craig had set up a lifting frame and kindly let us lower our gear with it. Another 50m drop is encountered to lower tanks and sundries on the deep side of the

cave. Weebubbie is almost recreational compared to the other sites. Following a 200 tonne rock collapse in 1996 the cave was closed and had only been recently re-opened for cave diving by the Department of Conservation and Land Management (DOLA W.A.). A party of S.A. divers, including members of the Addict club, were diving at the time of the collapse. I couldn't think of a more frightening experience, but that is the nature of the Nullarbor unpredictable.

Other improvements to Weebubbie include the installation of reflector markers in the dark section of the cave to assist cavers to easily follow the access walkway. I had a snorkel to the end of the 200 metre long, shallow entrance lake to where the main diving tunnel starts, just as the West Aussie trio commenced their dive. It was a spectacular light show as they turned on quartz cave diving lights in the crystal clear water and entered the gigantic submerged Weebubbie Railway Tunnel. The lights got progressively dimmer until I was left in total darkness as they disappeared from view. Margy and I dived the Tunnel that night, as the rest of our group arrived from Cocklebiddy to set up camp. Chris and Jeff again helped out by installing temporary aluminium extension ladders in the shallow end of the doline, but I, along with most of the others, opted for the 50m abseil.

The Railway Tunnel certainly lived up to expectations and really must be one of the all time cave dives. The tunnel is huge and so long, square and clear that your eyeballs almost pop out of your mask at the pristine white walls! Unfortunately the place is deep and in no time you are in 30-40 metres of water with close to 100m of rock over your head. The air supplies rapidly

dwindle, there is no time to relax as you reach 1/3s in the twin 100 cu ft tanks and it is time to begin the long swim home with a big deco stop back at the lake. Exhaustion and elation overcome you as you struggle out of the water and rid yourself of the heavy diving rig. My legs started to cramp at the end of the dive, I'm glad it happened then, because any problems back in the Railway Tunnel would have been diabolical.

Prior to retrieving our gear the next day, I finished my air in the 25 metre deep sinkhole next to the main Weebubbie lake. It was a little like a crystal clear Goulden's Hole, with snowflake silt and prolific "snot" cave growths in the deeper sections. I spotted a couple of small unidentified skeletons and some nice flint seams among the rocks. Our diving was finished for the trip, the others had to each lump three tanks out as stage bottles were used to gain some extra distance in the Railway Tunnel. Everybody had extended their personal boundaries on this trip. We hadn't tamed or beaten the Nullarbor, we simply survived.

Margy and I took the kids to Abrakurrie Cave, which is a dry feature to the west of Weebubbie. This cave must be one of the natural wonders of Australia, and it so easy to get into. A gentle walk down the doline brings you to an absolute behemoth of a cave. It is so big you could easily host an AFL Grand Final inside plus park a couple of jumbo jets in there as well! Fresh rock collapses reminded us of the active nature of these remote caves in the desert. It was time to leave, we packed the trailers and headed east, our view of cave diving changed forever!

COUNTRY FIRES REGULATIONS ON THE USE OF PETROL DRIVEN COMPRESSORS DURING THE FIRE SEASON

When applying for diving permits throughout the Fire Season from November to April, divers will need to state if they intend using a petrol driven compressor or generator.

Conditions are as follows:

- The space around and above is clear of flammable material to a distance of atleast four metres;
- A responsible person is in attendance at all times;
- A shovel or rake and portable water spray in good working order are at hand;
- Any exhaust is fitted with a spark arrester in good working order.



<http://artemis.eng.monash.edu.au/CDAA/>

PRIVILEGED ACCESS

I have given this brief column this title to attempt to reemphasis that access is a privilege not a right.

A number of access issues have been highlighted in the annual report however I would like to provide some further information about Tank Cave and Kilsby's.

Tank Cave

So far there have only been a limited number of members who have applied to dive in tank cave and they are diving the site quite regularly. I have had some members say that they do not agree with the principal of having to pay to access the site and it is too expensive. While both these points may have some validity there are certainly a number of sites overseas where payment is required for access. The fee of \$220 for two years is relatively cheap by world standards or compared to an overseas trip or even what many members pay for boat dives in 2 years.

Tank cave packages were mailed to all Penetration rated divers and whilst the paper work may appear daunting it is not as bad as it would first appear. Tank cave is Australia's Premier cave dive and is certainly worth the effort

involved in gaining access just ask members who have dived there.

It is important that all divers wishing to dive in tank cave maintain a certain level of diving currency. For first time Tank Cave divers and divers who have not completed group 1 dives (5 "gold line" dives) this is achieved by undertaking four dives in a range of penetration level sites within the last six months. If you have completed group 1 dives in the past but have not maintained currency this can be re-established by undertaking 2 "gold line" dives.

Kilsby's

Access to this site was denied for many years and when it was first reopened access was very limited. The current relatively liberal access conditions reflect the trust the landowner and lessee have in the CDAA and its members. Divers therefore have a responsibility to live up to that trust and the directorate will deal appropriately with members who choose to ignore the conditions of access. As a result of a number of incidents concerning access to Kilsby's Sinkhole the access conditions have been republished. I would however point out that if divers follow the

correct booking procedure as outlined in each edition of Guidelines then each group would receive a copy of the access conditions with their confirmation of booking. Please also note the change of address for Kilsby's bookings

Steve Arnel
Site Director

Site Access Conditions for Kilsby's Sinkhole

1. Access weekends are arranged by the site director or manager and published in Guidelines. This has generously been the first weekend of the month recently. Mid week diving is not permitted. Individual members are NOT to approach the landowner or lessee.
2. Divers wishing access are to write to "Kilsby's" 40 School Road, St Andrews. 3761. 4-6 weeks in advance detailing members of the group including the group leader and contact details, CDAA numbers and ratings. Divers must indemnify the South Australian Police Force before a booking can be confirmed and indemnities will be sent out if required. Priority will be given to those who have not dived the site before. Bookings will be confirmed by mail and a copy of the access conditions enclosed. A stamped self-addressed envelope MUST be enclosed with all applications.

3. Two groups of ten maximum, per day, per weekend, i.e. up to 40 individuals per weekend.
4. Divers will meet at the allotted time on the corner of the Sisters Road to enter the property as one group. All divers will exit together. Divers are not permitted to enter and or exit the property individually or in small groups except for emergencies. Groups will meet at 8:45am and enter the property at 9:00am and exit by 12 noon if they are not staying on the property for the second dive. The second group will meet at 12:45pm and enter at 1:00pm and exit by 4:00pm. It will be the same for both days. **NO ONE IS TO ENTER THE PROPERTY UNTIL ALL DIVERS HAVE ARRIVED.** Gates must be re-secured and disturbance to stock must be minimized
5. **NO VISITORS OR PETS ARE ALLOWED ON THE PROPERTY.**
6. All toilet requirements must be met before entering the property.
7. **A DEPTH MAXIMUM OF 40 METRES IS A LANDOWNER REQUIREMENT AND MUST BE ADHERED TO.**
8. **TWIN TANKS MUST BE WORN BY ALL DIVERS WHO MUST BE PROFICIENT IN THEIR USE.**
9. Groups may be checked that requirements are being met at any time during the day.

Not everyone's idea of fun

By Salli Makin

You are diving in a cave with absolutely zero visibility, buddy breathing and trying to reel in the thin orange line - the only thing connecting you with the surface and plenty of fresh air. Your ears pop as you lose buoyancy control and face-plant into the silt. Your breathing accelerates and, with both hands occupied with reeling, you rely solely on your buddy to place their regulator into your mouth so you can breathe.

It's not everyone's idea of fun but this is the "stress test" for the CDAA Cave Course and, as I discovered in September, passing is not straight forward.

I did not expect it to be easy. However, as an Open Water Instructor with over 400 dives logged, familiar with deep dives and using twin independents, and with almost 30 dives logged in Mt Gambier since my Cavern/Sinkhole Course five months earlier, I was feeling confident.

Yet, in the water, I found it a significant challenge to manage all the necessary tasks at once whilst buddy breathing. The problems of panic, losing buoyancy control and breaking the surface or loosing your sense of direction and heading back into the cave all result in "death" (in theory) and failing the test. To pass, practice is important but so too is mind control and trust in your buddy.

Firstly, our masks were taken off. As the cold water hit my face, I sucked in a big breath, almost losing control of my buoyancy. The tap came on my regulator - out of air - I spat it out and reached along the line for my buddy, felt for his mouth and grabbed his regulator, signalling at the same time by squeezing his arm rapidly five times (the emergency signal). I took the agreed two breaths and turned my head slightly to signal that he could take the regulator from my mouth.

Visibility was down to zero. With no masks, we were surrounded by a thick cloud of silt stirred up as we started buddy breathing. I groped around for the reel clipped to me and began to wind in the loose line hoping we had not become tangled. Completely disoriented, I felt for the line in front of me to discover the exit direction and began cautiously swimming forward, dragging my buddy along with me as he held the back of my neck for guidance.

My low-silting finning technique, the "frog kick", became very awkward with my buddy on my back and his legs entangling mine. I tried to rise away from the silty bottom, feeling for the direction of the line every metre or so to gauge our position in the water. Suddenly, the line led straight down and, for a fleeting moment, I thought we had started floating toward the surface. However, I

collected my thoughts, visualised the route that I had laid the line and remembered it was a tie-off on a log close to the bottom - a depth change being a course requirement. I pulled my buddy downward with me and I knew I was exerting myself. The two buddy breaths were not enough. My lungs were screaming and I turned my head to say I want air now!

As the regulator hit my nose (where did he think my mouth was!), I grabbed it, pushed it into my mouth and took three deep breaths. I waited for the regulator to come back and took another three breaths. I began to feel more in command. I told myself "I'm in control. I have plenty of air. I have a line to the surface. I'm in control..." As if, through repetition, I could will myself to believe it.

I undid the tie-off on the log and we continued following the line toward the surface, stopping at the tie-off points to signal OK to each other and squeeze out the air trapped in our dry suits. We reached the last tie-off before the surface - I recognised my knot made in the groove of the post worn by years of Cave Diving Courses. I quashed my sense of relief, as first we had to maintain neutral buoyancy and make our safety stop. Still buddy breathing, I counted out three minutes, second by second in my mind, and then signalled to my buddy that it was OK to ascend.

Breaking the surface, we punched the air in elation. There was a major sense of achievement that we had passed and could continue with the Cave Course.

However, I have to admit that I dreamt about the stress test for nights afterwards.

At the time, it was a serious game of mind control and approaching each element of the test logically and without rushing. Afterwards we laughed about the silty face-plants and head-butting logs and at least we provided our instructor, Warrick McDonald of AB Ocean Divers, with some occasional entertainment.

Our next three course dives were in cave-rated sites - and this is when it all started to seem worthwhile. Our first cave dive was in Allendale East which seemed so awesome, until it was surpassed by Pines and Fossil Cave the next day.

As Cavern/Sinkhole divers, we have heard others raving about the caves as we stood around getting tank fills at Phil Argy's in Mt Gambier. We've seen their photos and videos. But nothing compares to diving the caves yourself. The crystal clear water in which the other divers appear to be flying in mid-air, occasional fossils, exciting dark passages lit by just a torch beam and sun beams filtering down from the surface as you gaze up toward the cave entrance. It all adds up to be a spectacular experience.

Cave diving may not be everyone's idea of fun, but it sure is mine.

There are now four newly qualified cave divers who will be travelling the well-worn path from Melbourne to Mt Gambier - Rob Stewart, Rob Hair, Steve Graham and Salli Makin - with thanks to Warrick.

RECENT DOUBLE FATALITY

By Stephen G. Sturgeon

Please find below information on double fatality at Madison Blue Cave in Florida.

There where no DPV's involved in the drownings. All talk about DPV teams was hearsay. Most of the activity at Madison was on Saturday. Only a few teams went in on Sunday and the victims appear to be the only ones to go beyond the Half Hitch.

I would like to do a techniques session at the NACD workshop.

The report doesn't include our actual recovery procedures. Team Lamar Hires, Dell Motes, Mike Bruic. We went in expecting the worst, DPV's were mentioned but we saw no sign of DPV's in the vehicle. We went fearing they may be in the Courtyard. We looked for any signs of them going into side tunnels. Our first glimpse was their deco bottles at the Godzilla jump. We continued on, we were riding DPV's and carrying stage bottles. We found them at the Half Hitch and ditched our stage bottles. After taking notes on the scene, we unentangled them from the line. Mike reconnected the line and evaluated the half Hitch so see if it had collapsed again and found 3 safety reels deployed, 2 entangled and one unused. Dell and I readied the first diver for the exit. I had a line to tether from the first diver to Dell's DPV. I leave my DPV and ride the victim out to control buoyancy and steer. We pulled the one that had ditched his cylinders first. We returned and pulled second one with his cylinders on. The same procedure. Visibility was starting to drop. Mike had cleaned up our stages and the deco bottles of the victims. Dell and I returned for the double cylinders and my DPV. Visibility had dropped even more. At some points we had only 2 feet. We dropped Dell's DPV just past Martz Sink jump and swam on in. We got

my DPV and the Cylinders on the tether. We picked up Dell's DPV on the exit. Entire operation took only 65 minutes. We were able to upload their Nitek computers to find it looked like they expired after 135 minutes and total time to surface was 29 hr and 50 minutes.

There were a few loose ends on this recovery that have been cleared up. We had to retrieve the reels and look at what happened on the upstream side of the Half Hitch. Mike went in on Thursday afternoon to open up the restriction. When I arrived and prepared to dive the basin went milk white. We feared another collapse and didn't dive. Mike went in on Friday to find the Half Hitch just as he had left it after opening it up and got the missing details as to what happened on the upstream side of the Half Hitch.

No reels were jammed. One reel was deployed as if sweeping the tunnel (Mike

thought this one was jammed on first inspection) another was deployed and in the half hitch. Both were tied to the same outcropping. A third was lying on the bottom but not deployed.

The 900' line arrow was facing into the cave. Think they were confused and retraced their steps back into the cave to a secure point and another arrow facing out for reassurance. Now the profile on the computer upload makes sense. They was to much travel in this section of cave on the profile.

You are not asking any questions we haven't asked, but the nature of the situation only allows us to speculate. The team perished, there is no one to tell the story.

1) Did they run into problems early and it delayed their exit and endangering their air supply.

2) Did they spend less time at the Half Hitch and more time in the passage beyond. The profile graph can be misleading. In the near future I will try to repeat their dive to try and get a profile match to determine if less time was actually spent at the Half Hitch. For now it's only my opinion they spent most of the time at the Half Hitch(not in it) based on the information at hand. I feel low visibility was a contributing factor. With the flow at Madison it would have cleared if they were making forward progress. I think they spent a lot of time in one area thus never gaining visibility.

3) Martz Sink - They had a map in their vehicle of the site. Here again no survivor on the team to verify a dive plan and knowledge of the site.

4) If they were actually in the restriction for any period of time the profile graph would have shown this. They were moving around, the profile indicates 3 to 8 ft changes in depth every few minutes.

5) Gear configuration - This is not another stroke dies! these guys were very streamlined with their back mounts, long hoses wrapped and no extra equipment to get in the way. Canister lights on the belt. Very clean. Their stages are a different story but they were back at the Godzilla Room jump.

6) Did they run out of gas at the same time. I think they were very close on gas. Their deco/stages had the same pressure in them. If appeared one ran out before the other but I think they were close on air. The one that took his tanks off at the restriction ran out of gas first. Doesn't appear that hose was deployed. Even though they were off his back it was still tucked under the canister.

7) I can't say as to what they should have done, They ran out of time. Whatever happened, they made it to what should have been an easy exit zone but ran out of gas.

8) Prevention for future - lines - I know a number of sites where the main line is treated as nuisance and pushed out of the way, Devil's Ear for example at the lips. We should take time to route lines properly in low areas to ensure easy access in low visibility situations. Defining low visibility as silt, back up light exit or no lights. But now," WHO IS WE. That is the number one problem. Someone else should take care of this. I am not going to blow my dive to fix this problem. Some one else can. This is what I hear in the field. I have put 10's of thousands of feet of line in poplar cave site just to keep them safe but it's not my job. I just know it needs to be done. The line in the Half Hitch area needs to be evaluated for strength and replaced if needed and routed in a way to safely get people through it regardless of visibility. The restriction could be enlarged if someone wants to do it but this should be done on a weekday afternoon as not to jeopardize the safety of other teams.

9) As a community - We should re evaluate the training for lost line and lost diver scenarios. This makes two incidents this year of lost line. Training is only a tool to know how to practice a skill. It does not mean you will be safe. A successful lost line drill in class doesn't mean a cave diver can solve every situation. Reels verses spools. Hell, both work in a class situation but have it be the real McCoy. It will never be like the training experience. I personally think 50' to 60' of line on a reel is plenty. But the reel should never be more than 2/3's full. Most reel jams are from >packed reels. Most line searches never utilize more than 25 to 40 ft of line. Finger spools are ok for jumps and gaps but in the real world of zero visibility I usually have a death grip on the reel in my hand. I can't let the spool float between my fingers and feel in total control of the real while searching in zero visibility for a line or buddy. My two cents worth.

- Hells Hole** Contact ForestrySA by phone, fax or e-mail to arrange permit.
(e-mail preferred option)
- Pines** Collect Permit from Carter Holt Harvey Mill Gatehouse, Jubilee Highway Mount Gambier, adjacent to Forestry Office.
- Mud Hole** No diving on days of Total Fire Ban. Forest Work bans may be imposed by ForestrySA on extreme fire danger days, which exclude the public from entering the forest.
If in doubt, check with Ranger Trevor Wynniat, although signs are generally erected at diving sites on such days to indicate bans.
Permits will only be issued between 8:00am and 4:30pm
Monday - Friday.
Phone: (08) 8724 2876 Fax: (08) 8724 2885
or e-mail: wynniat.trevor@saugov.sa.gov.au
Hells Hole gate key available from Lady Nelson Visitor Centre.
- Iddlebidy (L250)** Iddlebidy open 1st and 3rd weekends of every month.
Nettle Bed open every weekend.
Maximum of 4 divers per dive per day, one dive per day for each site.
- Iddlebidy (L250)** Only Penetration Divers.
No diving on days of Total Fire Ban. Forest Work Bans may be imposed by ForestrySA on extreme fire danger days, which exclude the public from entering the forest.
If in doubt, check with the Ranger Trevor Wynniat, although signs are generally erected at diving sites on such days to indicate such bans.
Permits will only be issued between 8:00am and 4:30pm
Monday - Friday.
Phone: (08) 8724 2876 or Fax: (08) 8724 2885
or e-mail: wynniat.trevor@saugov.sa.gov.au
Site keys from Lady Nelson Visitor Centre.

Letter from a Member

I took great interest in the article in Guidelines 69 of the trip to the Nullarbor caves. It tells of a small party of divers leaving for a 12 day diving trip to dive 4 caves. In the article it goes on to say that a four and a half hour trip was undertaken to travel to Mt Gambier to meet with other divers and an overnight stay.

The following day the party of divers drove to Port Augusta, a trip of eight hours where a night was spent at a local motel. From Port Augusta the intrepid group drove a long haul of 11 hours to Border Village in SA for a well earned rest, again at a motel. The Monday morning saw a 3 hour trip get the group to Cocklebidy Roadhouse, WA.

I don't know about you but I'm exhausted just thinking about the mileage and the time it took, let alone diving for some days and then facing the trip back home. If you calculate the travelling times you will reach 49 hours, not to mention the further 264 kms from Cocklebidy to Eucla not mentioned on the return trip.

In total 5472.7 kms. Not a bad task for the Jackaroo and crew. So why am I making this point? Simple, there is another option open to all CDAA members, and that is to take only 9 and a half hours with a couple of stops along the way to stretch your legs. Yes that's right, FLY. Too expensive you think, NO. I did some calculations after reading Chris and Steve's WHAT IT TAKES and came up with some figures. I realise that a trip of this sort requires a ground support vehicle and crew, to travel ahead with all the equipment leaving the divers rested with a comfortable scenic flight.

A flight of this nature would happen in 2 three hour stages including refuelling and a three and a half hour final leg to cocklebidy. The total flight time for the entire trip would be only 19 hours. That's less than the total non stop return trip that our intrepid divers did in 1988.

I have been flying and piloting aircraft in and around Australia for over 20 years and have found that air travel in small aircraft has allowed me and my friends to travel to and see places that only a few have seen. I have also been diving for around the same time and believe it or not Flying and Diving can safely mix.

All my flying is done on a cost share basis which means we share the cost of the plane equally between those on board. There is no charge for the aircraft sitting on the ground, the only cost is while the engine is running. Yes I have my own aircraft and it can be made available to CDAA members at this cost structure. To charter one is substantially more costly.

If I have stimulated you in some way with this article please call me on Phone/Fax 03 52436711.

John Stewart CDAA 3323

CAVE DIVERS ASSOCIATION OF AUSTRALIA

1999 NATIONAL COMMITTEE ANNUAL REPORT

INTRODUCTION

This is my final report as National Director. I have decided not to renominate. Therefore I would like to take this opportunity to thank all those people who have assisted or provided support to the National Committee and me not only during this last year but also throughout my term as National Director. Without your ongoing support a number of this Committee's achievements would not have been possible.

There have been some changes to the make up the National Committee during this last year, however the cooperation between directors and their willingness to work together often outside their own areas of responsibility has resulted in relatively smooth and efficient administration of the Association.

This Committee's strategies, policies and programs were built from the ground up and based on member's wishes, but there has been some resistance to the changes. The selfish actions of a few people resulted in significant costs and penalties, which have been, and will continue to be borne by the majority of members. For example the National Committee could not move ahead in the areas of research and mapping because resources were heavily involved with the access arrangements for Tank Cave. My decision and that of other directors not to renominate has provided an excellent opportunity for these members to put their hands up and be counted; if they have the conviction to stand by their claims.

In this report I will outline achievements that the Association's members can be proud of and challenges for the incoming Committee.

25th Anniversary Celebrations

The 25th Year Anniversary was celebrated at the International Motor Inn. For the first time in recent history the Annual General Meeting was held on Saturday morning and was followed by a BBQ lunch. In the evening the Commemorative Dinner included a pre dinner address and keynote speech by Lamar Hires, noted cave diver/explorer and Managing Director of Diverite. Approximately 100 people attended the dinner. This was followed on Sunday morning by a demonstration by Lamar of his equipment configuration with particular attention given to his side-mount system utilising the Dive-rite Transpac harness.

Public Indemnity Insurance

Insurance remains a major issue for the Association. The public liability cover through Zuellig Insurance Brokers was renewed for this year. This policy provides for 10 million dollars cover in the event of a claim being made against the association or a landowner. Access to crown land and to many private properties is conditional on the Association indemnifying the land owner and/or land manager. The level of cover is dependent on the Association's rules and procedures being followed and that access is limited to sites deemed

to be under CDAA control. This level of cover is essential for the association to enjoy continued access to diving sites.

Because there seems to be some confusion regarding what or who is covered by the Association's policy let me stress now that the Association's cover does not protect members or any associate of the member in the event of an accident. It only covers the Association as a whole and any relevant landowners or managers. If you wish to be personally covered you must make your own arrangements.

Following on from my last report where I indicated that some changes were necessary to secure appropriate cover I can now report that a number of standards and procedures have been implemented. These include qualifications for cave diving supervisors (at sites where such supervision is required eg The Shaft and Tank Cave), the introduction of accident management plans and improved cave diving supervisor accountability.

Instructor Insurance

During the year, several diving instruction agencies withdrew their coverage for cave diving instruction. The Directorate is in the process of investigating alternative insurance arrangements, including the possibility of incorporating instructor cover in the Association's existing policy.

ASF/NSWSC Termination of Agreement

In April 1999 the agreements signed between the CDAA and the Australian Speleological Foundation and the NSW Speleological Foundation on 25th July 1993, were terminated by the CDAA.

The original agreement provided for:

Joint recognition of cave diving and caving protocols in place at the time of the agreement.

The CDAA and ASF to set up a joint working party to develop a set of common caving and cave diving standards.

To develop procedures for the recognition of alternative cave diving qualifications, including possible recognition of prior learning and or experience.

This agreement was to be binding for a period of at least two years, and then could be terminated with seven days notice.

The agreement was terminated by the CDAA for the following reasons:

The collaborative work that had been intended to be completed within the two year timeframe, had not been completed.

The ASF/NSWSC and the CDAA had independently developed their own set of policies relating to caving safety, conservation and ethics.

The final point related to the recognition of non CDAA trained cave divers. After significant discussion, including consideration of submissions from other technical dive training

agencies, it was decided by the Directorate to allow access to CDAA sanctioned sites to CDAA trained divers only.

SITE ACCESS

During 1998/99 our good standing with landowners has been maintained and I would like to thank Gary Barclay for all the work he has done in this area. The number of CDAA sites currently open is 33.

The major site access issue for the year has obviously been Tank Cave, Australia's premier advanced cave diving site. The site has been closed since July last year due to public liability issues and problems with access conditions. Thanks to a considerable amount of work done by the Directorate, the Association has entered into a license arrangement with the landowner for two years, which allows the CDAA to manage diving at the site. The license fee of \$7,500 pa is considerably less than the original \$10,000 discussed. Information packages have been posted to all current penetration divers. These detail the new arrangements that apply to new and returning divers to Tank Cave.

The main points are:

A non-refundable application fee of \$220 is payable for the 1999- 2001 period of the license. This fee may be reviewed when it becomes due for renewal, if the shortfall between revenue collected and the license fee is considered too great.

The current number of application fees paid is 18. — (\$3960).

A clearly defined schedule of progress through the cave is specified for new and returning divers alike

Access to the site has been increased to more than twice the number of days, and allows for more divers into the cave on any particular day.

The Tank cave access manager is now Jim Ferry.

Diving in Tank cave recommenced in August 1999

Access arrangements for the Shaft have been reviewed and published in Guidelines #69 in order to comply with the associations insurance policy and make the system run more smoothly. Many thanks to members acting as supervisors who maintain our access to this site.

Discussions took place with CALM concerning access to Warbla cave, however it is still considered to be a reference site and continues to be closed. CALM has requested that CDAA members respect this sites reference rating.

Additional sites at Rum Jungle and Berry Springs in the Northern Territory have been classified thanks to detailed submissions by David Cowan. Burrinjuck Cave that has been explored and mapped over the last seven years by a number of intrepid NSW divers is currently being reviewed for classification.

Training is once again occurring at Norman's Property on an ongoing trial basis thanks to negotiations undertaken by Gary Barclay.

A number of clean up activities took place during the year. Thanks once again to the ADDICT dive club who coordinated the Hell's Hole clean up with Trevor Wynniatt and the Primary Industries (Forestry) Department.

Heavy rain and blocked storm water drains resulted in large quantities of soil and wood chips from landscaping being washed into the Engelbrecht's East lake closing the site for a couple of weeks. Thanks to Ian Lewis who organised the clean up of the lake and improved our relationship with Lifeline who operate the site as tourist attraction.

The Mount Gambier City Council is supportive of the CDAA 's access to Engelbrecht's cave although they do have some concerns about noise at night. The CDAA's relationship with Lifeline has been strained by claims of lights being left on, considerable numbers of non divers accompanying divers and conflict between divers and Lifeline volunteers. I would request members respect Lifelines operation, turn lights off and comply with the honour system by contributing to the operating costs. The Directorate will deal with members who are identified infringing access arrangements at Engelbrecht's in order to maintain access for those who do the right thing.

Access to Kilsby's was maintained and if anything improved. Thanks to Steve Vanderstarre who has acted as access manager for some time but had to resign this year due to work commitments. Unfortunately we are currently going through the process of penalising a number of members for access infringements. Please remember access is a privilege not a right.

STANDARDS

The following key outcomes relate to the standards area:

- * Policies for the Use of Rebreathers, Manifolds and Enriched Air Mixtures in CDAA Rated Sites were brought before the Landowner Liaison Forum. These were ratified by the Forum and came into effect shortly afterwards when promulgated to members.
- * Cave level courses were reviewed to determine the reasonableness of the course being run by a single instructor. Single instructors for cave level course delivery came into effect during the year.
- * Implementation of new cave courses standards continued throughout the year. These were implemented on a trial basis and written comments from instructors will be included in the review process.
- * Instructor workshops were arranged and conducted in Victoria and NSW.
- * A number of member and instructor investigations were conducted into alleged breaches of the Associations rules.

- * Rationalisation and consolidation of the instructor and member records with the Records Officer.
Repackaging of student materials, certificates, applications and associated forms.
- * Instruction Materials now handled by Deb Williams. Many thanks to Peter Grills for his past work in this area.
- * Implementation of Investigations Officer policy.
- * Two instructor appointments were made during the year and instructor information published in Guidelines was reviewed.
- * Two penetration courses were conducted during the year with a majority of students passing.

PUBLICATIONS AND RECORDS

During 1998/99 there were 110 new members and as at 30 June the Association comprised of 771 members. Membership renewals have once again, as last year, have been slow. Unfortunately Guidelines can only be posted to Members who are financial.

Guidelines plays an increasingly important role as a forum in which Notices and site information can be sent to members. It is the face of the Association. The quality of material contained in and the timeliness of Guidelines has improved through the restructure of the National Committee and the good work of the former and current editors. The creation of the Publication and Records Director has achieved specific Director responsibility and accountability.

Despite the obvious need for this type of publication the cost of producing and distributing four issues in 1998/99 was \$16,350.00 including postage, for four issues. This represents a significant cost to the Association, approximately 25% of total expenses. Considerable work was done by Aqua Tech Australia to generate advertising revenue to help offset production costs, however this agreement has now lapsed. Clearly this is an area that will require specific attention in the coming year.

After criticisms last year renewal notices were included in the last two issues of Guidelines.

The Directorate made some initial progress in the area of Y2K compliance for the Association's records database and associated hardware. This is now a matter of top priority and it is expected to be completed before 31/12/99.

CDAA products have again provided a profit to the association. After work done by the then Products officer, Chris Edwards, (who is now the Publications and Records Director after Sabine Schnittger's retirement), the sales margins were reviewed, resulting in an increased return to the Association. The range of 25th Anniversary clothing proved to be particularly popular.

FINANCIAL

The Association has had another stable year financially, returning net income of \$17,850.00. The increase in insurance expense by \$5935.00 largely accounts for the reduction in net income from last year. Total income is virtually identical to last year. CDAA members total equity now stands at just over \$80,000.00. It is comforting to have these reserves, but there is a danger in becoming complacent, and allowing the hard work of the past few years to be eroded, thus restricting the scope for special projects, particularly in the research and mapping areas. It is also not entirely out of the question that other landowners may wish to charge a fee for access. The honour system at Engelbrechts has its faults, and Lifeline may insist on a more formal arrangement. Similarly, PISA have in the past, broached the subject of a user pays system, this is something that we as members may have to accept some time in the future. Access to Piccanninnie Ponds has been on a user pays system for some time now.

The issue of creating a paid position for the everyday administration of the association is another area that may require increased resources from the association. The complete lack of new nominations for Directorate positions highlights the reluctance of the membership to become involved in CDAA administration and further points to the inevitability of this course of action. Whether the members would support a fee increase for this purpose is something that would require a postal ballot to decide.

CAVE DIVERS ASSOCIATION OF AUSTRALIA

ACN 062 259 956

NOTES TO THE FINANCIAL STATEMENTS YEAR ENDING 30.6.99

1. Member's manuals have been included in the Trading account, even though they are not a specific sales item. They have been separated from Instruction materials in order to avoid distortion to the material's purchases figure.
2. During 1998/99 500 member's manuals were purchased. At current levels of new members, these should last from four to five years.
3. CDAA products net income slightly higher than last year, despite a lower gross sales figure. This follows an analysis of the sales margin and repricing where necessary.
4. The method of accounting for materials was changed this year from a simple revenue and expense basis to the trading account format presented here, so a direct comparison is difficult. In addition production cost increases have contributed to a slightly lower profit margin.
5. The net expense for member's manual production for this year has been shown as a loss in the trading account and transferred as an expense to the profit and loss account.
6. Accounting method changed - see note 4.
7. The breakdown for joining, (cavern), and rating upgrades - sinkhole, cave and penetration are: joining - \$2200, sinkhole - \$2160, cave - \$1020 and penetration \$180. They are all charged at \$20 per upgrade, ie 110 new members for 1998/99.

8. Aqua Tech Australia no longer handles Guidelines advertising. The figure quoted for advertising is based on expected revenues as at 30/6/99. Subsequent enquiries suggest it may be revised downwards in the order of \$500. Actual cash received for 1998/99 guidelines advertising was \$2100. The correct invoicing and collection of advertising revenue is an area that will require some attention in the future.
9. The \$1560 figure for 25th Anniversary receipts refers to amounts paid by members for the Dinner and Lamar Hires presentation.
10. The grant of \$1000 was made by the Mount Gambier City Council for CDAA 25th Anniversary celebrations. It was procured by Aqua Tech Australia P/L.
11. The reduction in interest income can be attributed to several factors. The most obvious one is that interest rates were lower than the previous year. The other is the Association's cheque account with the National Australia Bank does not pay interest, but it is not charged bank fees either. The previous ANZ cheque account did pay interest, but the bank fees were quite high.
12. A significant reduction in accounting and audit fees due to implementation of MYOB accounting software, and higher degree of preparation of Association's accounts by Treasurer.
13. Aqua Tech agreement has now officially lapsed. Commission expense paid on \$1000 grant from Mt Gambier City Council and cash receipts for Guidelines advertising of \$2700. \$600 of these receipts were for Advertisements in the 1997/98 year.
14. Bank fees refer to three separate cheques sent by members that did not clear. There was also a \$1.00 discrepancy between the accounting records and the bank statement. No other bank fees were charged. The savings in bank fees compared to the ANZ account are significant.
15. Credit facility charge of \$682.43 is significant, however approximately 40% of members have made use of credit cards to pay CDAA fees.
16. The public indemnity insurance premium increased significantly this year, and has largely contributed to the difference between last year's net profit figure of \$25,812.91 and this year's of \$17,850.14. The new premium became necessary due to the requirement from several government departments for a minimum of \$10 million public liability cover. The previous insurance cover also did not provide for such activities as dive site supervisors in such places as The Shaft and Tank Cave or cover the landowner's for the existence of fixed lines in dive sites and other issues specific to cave diving.
17. The figure for 25th anniversary expenses covers the Anniversary Dinner on, the member's BBQ and costs associated with printing and framing of certificates of appreciation for Landowners and other supporters of the CDAA.
18. Lamar Hires expenses include paying half of his airfare, accommodation at the 25th Anniversary weekend, meals and miscellaneous costs such as indemnities for Engelbrechts West and Piccanninie Ponds.

19. Guidelines production costs are for four issues as is the case for the 1997/98 figure.
20. Annual General meeting expenses comprise the printing and postage costs associated with the postal voting system as well as provision of copies of the financial statements at the AGM.
21. AGM Director's expenses include meals and accommodation at the International Motel for the five Directors, and related officials including the Treasurer and Records officer, for the AGM weekend.
22. Other meeting expenses cover all other expenses associated with official meetings of the CDAA Directorate and include State meetings, hearings into member transgressions, landowner liaison and site access.
23. In December 1998 an amount of \$30,000 was transferred to a National Australia Bank Term deposit. An amount of \$551.10 was paid in interest, however the bank mistakenly deducted withholding tax from this amount, resulting in the \$264.35 being credited to the account. The withholding tax has since been recovered and the Association's exemption from paying WHT has been made clear to the bank. The amount recovered was credited to the cheque account, but is included in the total interest income. The Term deposit currently earns around 4.8%p.a.
24. The ANZ Term deposit was closed and the proceeds transferred to the NAB cheque account. The reason it was closed was the return had fallen below that of the NAB Term Deposit, and it was felt to be more convenient to have all accounts with the same bank. The total paid from the ANZ Term deposit was the opening balance of \$8963.72 plus accumulated interest, (for the year) of \$424.67.
25. As mentioned in note 8, amounts owing on Guidelines advertising may need to be revised downwards, resulting in an advertising debtor's figure of approximately \$1000.
26. The \$203.55 withholding tax figure refers to the ANZ Term deposit. It was recovered from the Australian Taxation Office after June 30th 1999. The interest income, upon which the WHT was levied, was reported in the 1996/97 CDAA Profit and Loss accounts and as such will have no effect on the 1999/00 Financial Statements.
27. During the 1998/99 financial year an Instructor's manual was transferred from Instruction materials for Directorate use. This accounts for the \$100 increase in the Property, Plant and Equipment figure from last year. The increase of \$69.95 in the Office Equipment figure refers to a File Reader program purchased by the Guidelines Editor for Guidelines production.
28. Accrued expenses are amounts relating to the 1998/99 financial year, but unpaid at June 30th 1999. They comprise \$27.70 payable to the Treasurer for postage and refreshments at a Director's meeting. An amount of \$756.00 payable to McMillan Knitting Mills for CDAA clothing and an amount of \$289.85 payable to the National Director for AGM expenses. These amounts have been paid since June 30th 1999.
29. The \$150 creditor figure relates to a refund owing to a member that was unpaid as at June 30th 1999.

CAVE DIVERS ASSOCIATION OF AUSTRALIA INCORPORATED
ACN 062 259 956
TRADING ACCOUNT FOR YEAR ENDED JUNE 30 1999

SALES:	1999	1998	note
CDAА Products	\$ 6,831.55	\$ 7,784.90	
Instruction Materials	\$10,225.00	\$ 9,670.00	
LESS COST OF SALES:			
OPENING STOCK:			
CDAА Products	\$ 1,687.84		
Instruction Materials	\$ 315.00		
Members Manuals	\$ 650.00		1
ADD PURCHASES:			
CDAА Products	\$ 8,738.58		
Instruction Materials	\$ 2,574.73	\$ 1,982.09	
Members Manuals	\$ 3,943.45		2
LESS CLOSING STOCK:			
CDAА Products	\$ 5,230.46		
Instruction Materials	\$ 57.58		
Members Manuals	\$ 3,521.70		
TOTAL COST OF SALES:			
CDAА Products	\$ 5,195.96	\$ 5,723.49	
Instruction Materials	\$ 2,832.15		
Members Manuals	\$ 1,071.75		
GROSS TRADING PROFIT(LOSS):			
CDAА Products	\$ 1,635.59	\$ 2,061.41	
Instruction Materials	\$ 7,392.85	\$ 7,687.91	
Members Manuals	-\$ 1,071.75		
LESS:			
Postage:			
CDAА Products	\$ 139.55	\$ 300.35	
Instruction Materials	\$ 389.50	\$ 520.95	
NET PROFIT(LOSS):			
CDAА Products	\$ 1,496.04	\$ 1,141.76	3
Instruction Materials	\$ 7,003.35	\$ 7,166.96	4
Members Manuals	-\$ 1,071.75		5

Andrew Seifried
CDAА Treasurer

CAVE DIVERS ASSOCIATION OF AUSTRALIA INCORPORATED
ACN 062 259 956
STATEMENT OF INCOME AND EXPENDITURE FOR THE YEAR ENDED JUNE 30 1999

INCOME:	1998/99	note	1997/98	1996/97
CDAА Products net income	\$ 1,496.04	\$ 1,496.04	\$ 1,141.76	\$ 661.92
CDAА Instruction Materials net income	\$ 7,003.35	6	\$ 7,166.96	\$ 2,400.00
Membership fees	\$38,570.00		\$38,755.00	\$37,735.00
Instructor's membership fees	\$ 1,310.00		\$ 1,440.00	\$ 1,045.00
Late membership fees	\$ 3,670.00		\$ 1,795.00	\$ 355.00
Joining and rating upgrade fees	\$ 5,560.00	7	\$ 5,880.00	\$ 4,450.00
Nitrox endorsement fees	\$ 1,110.00		\$ 1,210.00	\$ 80.00
Guidelines advertising income	\$ 3,650.00	8	\$ 2,550.00	\$ 5,565.00
CDAА Fundraising income			\$ 1,355.00	
25 Anniversary receipts	\$ 1,560.00	9		
Grants and Donations received	\$ 1,000.00	10	\$ 1,590.00	\$ 10.00
Fines	\$ 48.00		\$ 200.00	
Penetration course receipts	\$ 7,240.00		\$ 6,680.00	
Interest income	\$ 975.77	11	\$ 1,594.86	\$ 1,109.02
TOTAL INCOME	\$73,193.16		\$73,861.62	\$60,389.94
EXPENSES:				
Administrative expenses			\$ 33.00	
Audit fees	\$ 350.00	12	\$ 925.00	\$ 750.00
Aquatech commission expense	\$ 740.00	13	\$ 1,043.63	
Bad debts expense (Advertising)			\$ 762.00	\$ 2,320.00
Bad debts (other)	\$ 20.00			
Bank fees	\$ 28.00	14	\$ 288.80	\$ 461.33
Computer expenses	\$ 335.00			
Courier/Taxi fares	\$ 132.72			
Credit facility fees	\$ 682.43	15	\$ 66.00	
Govt. financial taxes	\$ 175.15		\$ 208.84	
Depreciation expense	\$ 2,861.65		\$ 3,643.50	\$ 3,309.00
Discounts allowed (advertising)	\$ 100.00			
Insurance: Public liability	\$ 9,325.00	16	\$ 3,390.00	\$ 8,802.00
Insurance: CDAА Products				\$ 245.55
Members Manuals Printing	\$ 1,071.75			
Postage	\$ 2,614.95		\$ 2,507.59	\$ 2,383.56
Printing and Stationery	\$ 1,053.47		\$ 3,133.42	\$ 8,029.00
Penetration course disbursements	\$ 7,200.00		\$ 6,400.00	
Repairs & Maintenance			\$ 191.83	
Research and Mapping expenses	\$ 20.00			
Site expenses	\$ 171.50		\$ 70.00	\$ 46.85
Sundry expenses			\$ 251.55	

Subscriptions			\$ 50.00	\$ 55.00
Telephone	\$ 3,001.21		\$ 1,953.53	\$ 3,987.13
CDAA Fundraising expenses			\$ 708.00	
25 Anniversary expenses	\$ 2,402.12	17		
Lamar Hires expenses	\$ 2,233.21	18		
Guidelines production	\$14,514.90	19	\$14,138.88	\$10,926.64
Guidelines postage	\$ 1,833.62		\$ 1,240.21	
Annual general meeting expenses	\$ 1,446.05	20	\$ 1,381.11	\$ 1,870.35
AGM Directors expenses	\$ 940.14	21		
Other meeting expenses	<u>\$ 2,090.15</u>	22	<u>\$ 3,158.78</u>	<u>\$ 2,776.43</u>
TOTAL EXPENSES	\$55,343.02		\$48,048.71	\$46,372.84
NET INCOME	<u>\$17,850.14</u>		\$25,812.91	\$14,017.10

CAVE DIVERS ASSOCIATION OF AUSTRALIA INCORPORATED
ACN 062 259 956
BALANCE SHEET AS AT JUNE 30 1999

ASSETS

	1998/99	note	1997/98	1996/97
Current Assets				
National Australia Bank Cheque account	\$55,752.63		\$62,245.92	\$29,370.42
National Australia Bank Term Deposit	\$30,264.35	23		
ANZ term deposit		24	\$ 8,963.72	\$ 8,629.78
Debtors-(Advertising)	\$ 1,550.00	25	\$ 700.00	\$ 3,552.00
Debtors-(CDAA Products)			\$ 1,449.00	
Debtors-(Other)	\$ 50.00		\$ 20.00	
Withholding Tax Deducted	\$ 203.55	26	\$ 203.55	\$ 203.55
CDAA products closing stock	\$ 5,230.46		\$ 1,707.69	\$ 4,887.16
Instruction packages closing stock	\$ 57.58		\$ 1,065.00	
Members Manuals closing stock	<u>\$ 3,521.70</u>			
Total Current Assets	\$96,630.27		\$76,354.88	\$46,642.91
Non-Current Assets				
Property, Plant & Equipment	\$ 7,169.70	27	\$ 7,069.70	\$ 5,119.70
less: accumulated depreciation	-\$ 5,390.00		-\$ 4,045.00	\$ 2,801.00
Office equipment	\$11,203.59	27	\$11,133.64	\$ 9,724.20
less: accumulated depreciation	<u>-\$10,142.15</u>		<u>\$ 8,625.50</u>	<u>\$ 6,226.00</u>
Total Non-Current Assets	\$ 2,841.14		\$ 5,532.84	\$ 5,816.90
TOTAL ASSETS	<u>\$99,471.41</u>		<u>\$81,887.72</u>	\$52,459.81

LIABILITIES

Current Liabilities

Memberships received one year in advance	\$12,695.00	\$16,000.00
Instructor fees received one year in advance		\$ 40.00
Overpayments	\$ 500.00	\$ 350.00
Penetration course deposits	\$ 400.00	
Accrued expenses	\$ 1,073.55	28
Creditors	\$ 150.00	29

Total Current Liabilities \$14,818.55 \$16,390.00

Non-Current Liabilities

Memberships received two years in advance	\$ 3,050.00	\$1,895.00
Memberships received three years in advance	\$ 650.00	\$ 350.00
Memberships received four years in advance	\$ 50.00	\$ 150.00
Memberships received five years in advance		\$ 50.00

Total Non-Current Liabilities \$ 3,750.00 \$ 2,445.00

TOTAL LIABILITIES \$18,568.55 \$18,835.00 \$15,220.00

EQUITY

Member's Equity as at 30/6/98	\$63,052.72
add: 1998/99 Net Income	<u>\$17,850.14</u>

CDAA Member's Total Equity as at 30/6/99 \$80,902.86 \$63,052.72 \$37,239.81

represented by:

NET ASSETS \$80,902.86 \$63,052.72 \$37,239.81

REMINDER TO ALL INSTRUCTORS
RENEW YOUR MEMBERSHIP
BY 31/12/99.

TANK CAVE DIVING SCHEDULE 2000

JANUARY 2000	DATE	FEBRUARY 2000	DATE
Saturday	15th	Saturday	12th
Sunday	16th	Sunday	13th
Saturday	29th	Saturday	26th
Sunday	30th	Sunday	27th
MARCH 2000	DATE	APRIL 2000	DATE
Saturday	11th	Saturday	8th
Sunday	12th	Sunday	9th
Monday (Labour Day VIC)	13th	Friday (Good Friday)	21st
Saturday	25th	Saturday	22nd
Sunday	26th	Sunday	23rd
		Monday (Easter Monday)	24th
		Tuesday (ANZAC Day)	25th
MAY 2000	DATE	JUNE 2000	DATE
Saturday	13th	Saturday	10th
Sunday	14th	Sunday	11th
Monday (Adelaide Cup)	15th	Monday (Queen's Birthday)	12th
Saturday	27th	Saturday	24th
Sunday	28th	Sunday	25th
JULY 2000	DATE	AUGUST 2000	DATE
Saturday	8th	Saturday	5th
Sunday	9th	Sunday	6th
Saturday	22nd	Saturday	19th
Sunday	23rd	Sunday	20th
SEPTEMBER 2000	DATE	OCTOBER 2000	DATE
Saturday	2nd	Sunday	1st
Sunday	3rd	Monday (Labour Day SA)	2nd
		(Queen's Birthday WA)	
Saturday	16th	Saturday	14th
Sunday	17th	Sunday	15th
Saturday	30th	Saturday	28th
		Sunday	29th
NOVEMBER 2000	DATE	DECEMBER 2000	DATE
Saturday	11th	Saturday	9th
Sunday	12th	Sunday	10th
Saturday	25th	Saturday	23rd
Sunday	26th	Sunday	24th

TRADING POST

FOR SALE

Nikonos V camera with Sea&Sea
(yellow sub 100) TTI strobe.

\$1100

Never been flooded and used
mainly in fresh water.

Stewart German (03) 5335 9776

FOR SALE

Dive rite superwings \$650.

WANTED

Mako or Techna scooters and
parts any condition.

Further Details (03) 9499 9207

FOR SALE

2 x AL 2000 light systems

2 x complete extra tops with coily cables and light heads

2 x chargers

2 x butt mounts (webbing harness) neoprene covers

2 x spare 4ak batteries

COST ONLY \$700.00

(Will consider separating).

Paul Axton 0414 346 442

NOTICE • NOTICE • NOTICE • NOTICE

MEMBERSHIP FEE DEADLINE

Section 13(3) 13(4) of the Constitution (as amended) September 1997, requires that membership fees are due 1st July of any membership year. Any member who has not paid by 1st September is deemed to be unfinancial. A \$50 late fee as specified in Schedule 2 of the regulations is payable in addition to membership fee in order to regain membership.

Remember that in order to nominate a Director, second a nomination or vote in the postal ballot, you must be a financial member of the Association (Section 9(2), 9(6), S13 (1) Constitution).

ANY MEMBERSHIP RENEWALS THAT ARE RECEIVED BY THE TREASURER AFTER CLOSE OF BUSINESS **WEDNESDAY 1ST SEPTEMBER 1999** WILL ATTRACT A LATE FEE. **THERE WILL BE NO EXCEPTIONS.**

If you have not already renewed. DO IT NOW!

MOUNT GAMBIER

The Barn Motel

★★★★ RAA

Set on 12 acres – Quiet Location

- Central to Piccaninnie & Ewen Ponds
- Light breakfast included in moderate tariff
- Special rates for small group bookings
- Next door to Barn Steak House
- Undercover BBQ area, kitchen facilities
- Storage shed available

***The perfect place to spend
your holiday***

Ph: (08) 8726 8366

Fax: (08) 8726 8333

NELSON ROAD, MOUNT GAMBIER

DIRECTORATE POSITIONS

The Directorate would like to welcome on board Paul Axton as Standards Director who has been appointed under section 20.4.b

Paul replaces Glen Harrison who stepped down at the AGM. On behalf of all members, I thank Glen for all the work he has performed in that role and other roles he has had in the past.

Paul's contact number is 0419 346 442.

The position of National Director is still currently vacant. The rest of the Directorate is temporarily filling the duties.

WANTED



ARTICLES FOR GUIDELINES

**IF SIGHTED PLEASE SEND IMMEDIATELY,
TOGETHER WITH ANY PICTURES TO:**

The Editor, Glenn O'Connell

P.O. Box 290, North Adelaide, S.A. 5006.

REWARD

An even better Guidelines for everyone.

CDAA SITE ACCESS

Remember: Access is a privilege, not a right. Please be considerate of landowners wishes.

CN = CAVERN S = SINKHOLE C = CAVE P = PENETRATION

SITE	LEVEL	OWNER	ACCESS DETAILS
MOUNT GAMBIER - SOUTH AUSTRALIA			
Ewens Ponds	Nil	DENR P.O. Box 1046 Mt Gambier 5290 (08) 8735 1177	Groups of 6 or more, phone/mail to Dept. of Environment & Natural Resources (DENR). Smaller groups, no need. Indemnity form to be completed.
Horse & Cart Tea Tree	CN CN	Peter Cunningham PO Box 643, Mt Gambier 5290	By phone or mail, 1 week prior. Ph: (08) 8738 4003.
Little Blue	S	Port MacDonnell	Little Blue - permission not required - must carry card.
Allendale	C	Port MacDonnell	Obtain key from Mt. Gambier Tourist Information Centre.
Gouldens 2 Sisters Fossil	CN CN C	DENR P.O. Box 1046 Mt Gambier 5290 Ph: (08) 8735 1177	General Diving: Divers to contact DENR and notify of date and site to be dived. Divers must have the correct CDAA diving endorsement for the site. The onus of proof of CDAA status is on the diver and is provided by presentation of CDAA membership card or DENR checking the membership list supplied by CDAA. If there are problems with the diver not being a current financial member DENR will not be chasing the records officer to sort out the problem. This will be the responsibility of the diver. The diver must have signed an indemnity with DENR before access is permitted. Training: The Instructor is to notify DENR of the date the sites are needed and to forward signed indemnities from each student and their temporary card number. membership number.
Ela Elap One Tree	S S	Mr. Peter Norman Private Bag 67, Mt Gambier 5290	By phone or drop in before diving. Ph: (08) 8738 5287
Swim Through	C	Valerie Earl PO Allendale 5291	Currently CLOSED pending new access arrangements.
Piccaninnie Ponds	S	DENR P.O. Box 1046, Mt Gambier 5290	Permit holders by phone. Be aware of delicate vegetation. Indemnity form to be completed. Ph: (08) 8735 1177 Faxed copies of cards no longer accepted when booking.
Hells Hole Pines Mud Hole	S P/C C	ForestrySA PO Box 162 Mt Gambier 5290	Contact ForestrySA by mail, phone or fax to arrange permit. Collect permit from Regional Office, Jubilee Hwy., Mount Gambier. No diving on total fire ban days. Forest Work Bans may be applied by PISA Forestry if forest fire danger is expected to reach extreme. Such bans also exclude the public from entering the forest. If in doubt, please check with Trevor Wynniat, although signs are generally erected at diving sites on such days to indicate such bans. Permits will ONLY be issued Mon-Fri between 8.30am-4.30pm. Ph: (08) 8724 2876 Please use this number for all bookings and enquiries etc. Fax: (08) 8724 2885 Email: wynniat.trevor@saugov.sa.gov.au. Written confirmation required.
Kilsby's	S	Landowner leased to S.A. Police	Restricted access conditions apply - refer Guidelines Issue 54. Twin tanks, maximum of 40 metres depth. Write to: 40 School Road, St. Andrews 3761, Email: mpain@hipex.com.au, 4 to 6 weeks prior to wanting to dive. Please enclose stamped self-addressed envelope (Do not contact landowner). Dec 4/5, Jan 1/2, Feb 5/6, Mar 4/5, Apr 1/2, May 6/7, Jun 3/4. 9am - 12pm & 1pm - 4pm. No animals permitted. No mid-week diving.
Shaft	S	Generally open one weekend a month L. Claridge P.O. Box 290 North Adelaide 5006	For access dates contact Linda Claridge. Also, see Special Access Bulletin in Guidelines issue 69. Nitrox as a diving mix is not allowed in the shaft. Deco mixes ATTACHED to a shot line are permissible. Divers applying to dive in the Shaft must have documented experience of a least 5 twin-tank dives.
Ten Eighty Bullock Hole Black Hole	S S S	Mr. Colin Traeger PO Box 12, Mt Gambier 5290 (087) 26 6215	Sundays only Mail Booking Form to Colin Traeger 2-6 weeks prior, stating names/qual. of all divers, and time slot. Please include stamped self addressed envelope. Closed October to November for shearing.

CDAA SITE ACCESS

SITE	LEVEL	OWNER	ACCESS DETAILS
MOUNT GAMBIER - SOUTH AUSTRALIA (continued)			
Max's Hole	C		Phone or mail 1 week prior to dive. Ph: (08) 8726 8277 Currently closed pending access arrangements with new owner.
Hann's cave	P	P & A Lasslett	Groups of four divers only apply in writing to Site Director. Limited groups will be allowed access over the summer months. The site is very delicate and therefore only limited access is available. Divers applying will be notified as to further access details. Please include a stamped self addressed envelope.
Engelbrechts - East - West	C P	Mt Gambier Council	Obtain key from Mt Gambier Tourist Information Centre. Access agreement must be signed prior to diving. Key must be returned by 5pm Sunday, 2 divers must sign out keys, all divers must sign in advising which groups they are diving with.
Three Sisters	P	Millicent Council	Contact Linda Claridge (Records' Officer). Access available for experienced Penetration divers only. Low profile or side mounted independent air systems required. Access agreement must be signed prior to diving. Please allow 4 weeks for indemnities to be processed.
Iddlebiddy (5L250) Nettle-Bed (5L290)	P P	ForestrySA PO Box 162 Mt Gambier 5290	5L250 open 1st & 3rd weekend of every month. 5L290 open every weekend. Max. 4 divers per dive per day, 1 dive per day for each site. Only Penetration divers completed practical in-water cross-over. Bookings from Forestry Office - key from Lady Nelson. Contact ForestrySA by mail, phone or fax to arrange permit. Collect permit from Regional Office, Jubilee Hwy., Mt. Gambier. No diving on total fire ban days. Forest Work Bans may be applied by PISA Forestry if forest fire danger is expected to reach extreme. Such bans also exclude the public from entering the forest. If in doubt, please check with Trevor Wynniat or Forestry Office, although signs are generally erected at diving sites on such days to indicate such bans. Permits will ONLY be issued Mon-Fri between 8.30am-4.30pm. Ph: (08) 8724 2887. Please use this number for all bookings and enquiries etc. Fax: (08) 8724 2885 Email: wynniat.trevor@saugov.sa.gov.au. Written confirmation required.
McKay's Shaft	S		Contact Phil Argy at Mt. Gambier as access can be arranged.
Tank Cave	P	Mr. DYCKER	Tank Cave Access Manager: Jim Ferry Ph: 0417 862 351. For access details see Special Bulletin No. 7 in Guidelines issue 69.
Baker's Cave	C		Please write to the Site Access Director to dive in Baker's Cave. Include stamped self-addressed envelope. Climbing equipment required.
NULLARBOR - WESTERN AUSTRALIA			
Cocklebiddy Murra El Elevyn Tommy Grahams Weebubbie	C P/C C C		Apply in writing for permission to dive at least 4 weeks in advance of trip to: District Manager, C.A.L.M., PO Box 234, Esperance, W.A. 6450. Phone: (08) 9071 3733 Fax: (08) 9071 3657 Apply in writing with at least 4 weeks notice to: Graham Higgins, Dept. of Land Administration, PO Box 2222, Midland, W.A. 6056. Include in the application: • The dates of the intended visit(s) • Photocopies of CDAA certification cards for all of the party • A signed Indemnity Form for Weebubbie Cave (photocopy from original in Issue 61 of Guidelines). Please note that this arrangement is for Weebubbie only and access to other caves on the Nullarbor must follow existing access protocol. Also note that divers must supply their own ladders as the old ladder has been removed.
WELLINGTON CAVES - N.S.W.			
Limekiln (McCavity)	P/C		Both Penetration and Cave Level are being accepted for this cave depending on it's water level at the time. The cave has a restriction at the entrance which is underwater making it a Penetration Dive. During drought, the water level drops to form a small lake below the restriction allowing experienced Cave Divers access to this delicate cave.
Water (Anticline)	C		Affected by high CO ₂ levels during Summer/Autumn. Access arrangements are co-ordinated with an already commissioned research group. Contact Greg Ryan (02) 9351 4809 w, (02) 9743 4157 h, greg@cs.su.oz.au.
Rum Jungle Lake Berry Springs	S		No specific access arrangements.

FOR SALE

Cave/tech diving light,
all marine anodised aluminium,
12v 15amp hour battery, 100w,
50w or 30 watt bulb, compact
head, switch on battery pack,
charger, as new \$600.

Neil Vincent (02) 971 798
email neilv@ozemail.com.au

FOR SALE

CUSTOM-BUILT DIVE TRAILER

6 x 4 Trailer - Lift Up Hood style with:

Deadlocks on both sides for security; Built-
in partitioned storage for 6 tanks each end,
leaving space for heavy weight belts, etc in
the middle of trailer over axle;

Brand new floor; New professional paint
job; and Electrical brakes on trailer.

This trailer will comfortably take 4
people's dive gear to Nullabor or
would suit professional dive instructor.

\$1500

Call Glenn on 0411 704 758 or
(H) 03 9432 3489

FOR SALE

AS NEW with instruction manuals & all in
original boxes - used mainly in fresh water:

- Nikonos 4A
- 35mm Lens
- SB101 Flash
- 28mm Lens
- Pelican Case
- Difuser
- 15mm Lens (incl. view finder)
- Close Up Lens (outfit)

Further details

(08) 8336 1616

FOR SALE

Two 63 cubic ft
aluminium tanks, with
stainless steel bands.
\$320 the lot.

Phone Clive Wheeler
CDAA 2409
8298 5952

FOR SALE

1 x Diverite Neutralite with MR 16 head,
brand new batteries \$550

3 wings, backplate and harness sets good
condition \$350

2 x Cochran nemesis II Nitrox air integrated
2 mix computers \$800 each

2 x Cochran nemesis IIa Nitrox air
integrated 3 mix computers \$900 each

Stephen G Sturgeon 9527 7667

GUIDELINES DEADLINES

If you would like to contribute to
Guidelines, you should note the
following deadlines for
submission of materials:

Deadline	for publication
20th February	March
20th March	June

NOTICE FOR INSTRUCTORS

Procedure for ordering student packs:

1. Check you are insured & financial.
2. Send order & cheque or by phone/credit card.
3. Allow 14 days from when the order is received -
so allow plenty of time.
4. Student kits cannot be returned.
5. Instructors must be active.
6. Please do not pass my number on to dive shops -
you should deal with them not me.

• INSTRUCTOR RENEWALS •

Several instructors have not yet renewed their CDAA
ratings. Instructors must lodge their current insurance
details and renewal fee or packages will not be issued
and certifications rejected.

Instructor Renewals, PO Box 15, KOROIT 3282

Deb Williams
Instructor Materials Officer

ACTIVE CDAA INSTRUCTORS

Any Instructor wishing material contact - (03) 9543 3930 or email: deb@agents.com.au

STANDARDS DIRECTOR:

Glen Harrison
Telephone: 0407 608 609
(email) harrison.glen@saugov.sa.gov.au

INSTRUCTOR	CN	S	C	STATE	PHONE	INSTRUCTOR	CN	S	C	STATE	PHONE
NSW & ACT						WESTERN AUSTRALIA					
Nick Jones	•	•		ACT	015 851 313 m	Gary Bush	•	•	•	WA	0417 957 620 m
Peter Grills	•	•	•	NSW	(02) 4950 6262 (8am - 12 midday)	Marilyn Boydell	•	•	•	WA	(08) 9349 5646 h
Gary Norgard	•	•		NSW	(049) 68 4588 h	Steve Sturgeon	•	•	•	WA	(08) 9527 7667 h/w 0418 940 143 m
Andrew Robertson	•	•		NSW	(02) 9525 0995 h 0414 412 563 m						
Des Walters	•	•	•	NSW	(060) 411 405 w						
Liz Butler	•	•		NSW	0409 463 176						
SOUTH AUSTRALIA						VICTORIA					
Greg Bulling	•	•	•	SA	014 477 430 m (08) 8265 4978 h	Stephen Arnel	•	•	•	VIC	(055) 26 5230 h
Glen Harrison	•	•	•	SA	0407 608 609 m (08) 8386 3237 h	Gary Barclay	•	•		VIC	(03) 5565 8793 h
John Hanson	•	•		SA	(08) 8269 1083	Jane Bowman	•	•		VIC	(03) 9579 2600 w
Max Marriot	•	•	•	SA	(08) 8447 3360 h	Stan Bugg	•	•	•	VIC	(03) 9379 8791 h
Richard Megaw	•	•	•	SA	(08) 8344 1733 h	Linda Claridge	•	•	•	VIC	(03) 5565 8793 H
Richard McDonald	•	•	•	SA	(08) 8295 4140 h/w	Brian Cornell	•	•	•	VIC	(059) 85 2514 h
						John Dalla - Zuanna	•	•	•	VIC	015 887 060 m
						Chris Edwards	•	•	•	VIC	0417 116 372 m
						Barry Heard	•	•	•	VIC	(056) 27 6474 h 019 401 469 m
						Ian Lewis	•	•	•	VIC	015 284 051 m
						Warrick McDonald	•	•	•	VIC	(03) 9579 2600 w
						Bob Wealthy	•	•	•	VIC	(056) 858 338 h
						Frank Zeigler	•	•	•	VIC	(055) 236 392

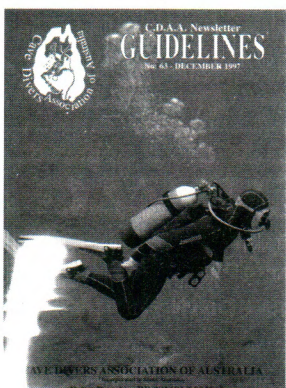

LIKE
TO
SEE
YOUR
PHOTO
ON
THE
COVER?

**WE'RE CONSTANTLY SEARCHING FOR PICTURES TO USE
FOR THE COVER OF GUIDELINES - SEND THEM TO:
THE EDITOR, P.O. BOX 290, NORTH ADELAIDE, S.A. 5006**

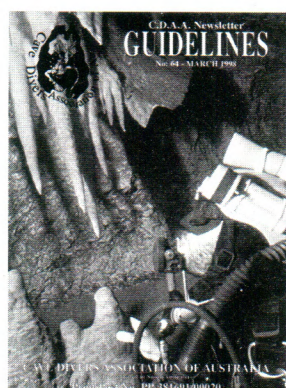

**Please make payable to:
CDAA, P.O. BOX 290
NORTH ADELAIDE, SA 5006**

	QTY/ COL/SIZE	ITEM	UNIT PRICE	TOTAL	
BOOKS		Cave Diving Communications. A manual from NSS - CDS dealing exclusively with all underwater communications used in cave diving. Including touch, torch and line signals, and use of line arrows and jump reels. A must for all cave divers bookshelves.	\$15.00		
		Cave Diving - A Blueprint for Survival. A book by the world-renowned cave diver, the late <i>Sheek Exley</i> , this is a case study of a number of accidents that have occurred in the USA and how to avoid them.	\$15.00		
		Basic Underwater Cave Surveying. The standard publication for anyone remotely interested in research and survey techniques used in water filled caves.	\$15.00		
		CDAA Occasional Paper No. 2, From National Conference 1981. Includes topics such as Fossil Cave, Belay Techniques and Cocklebidy 1979.	\$2.00		
		S.R.T. Single Rope Techniques. Published by the Sydney Speleological Society. This is the definite work on all aspects of vertical travel in caves. Should answer most questions on rope work for cavers and cave divers alike.	\$27.00		
		DAN Emergency Handbook. Revised 1995 edition by Lippmann and Bugg. Printed on waterproof paper this essential first aid manual should be part of every cave divers' kit.	\$17.00		
		NSS Cave Diving Manual. The standard reference manual in cave diving covering just about every conceivable topic. New Edition.	\$50.00		
		Wukulla Springs Project. The U.S. Deep Caving Team, edited by William C. Stone.	\$67.00		
		The Darkness Beckons. by Martyn Farr. The history and development of cave diving.	\$55.00		
		Deep Diving. by Bret Gilliam, Robert Von Maier. An advanced guide to physiology procedures and systems.	\$30.00		
VIDEOS		Deep Into Blue Holes. by Rob Palmer. This is the project manual written about his trips to the Bahamas, diving some of the most advanced and spectacular caves in the world.	\$40.00		
		NSS Cavern Divers' Manual. The standard reference manual in cavern diving covering almost every conceivable topic. Also most principles behind safe sinkhole and cave diving.	\$18.00		
		Caverns Measureless to Man. <i>Sheek Exley</i> .	\$46.00		
		Cave Practice & Equipment. Edited by David Judson British Cave Research Association. Updated 295 Page book fully illustrated with over 200 line drawings & 33 pages of dramatic photographs. Full chapter on cave diving by Martyn Farr.	\$40.00		
		New Edition of Peter Horne's Lower South East Cave Reference. An illustrated catalogue of the Lower South East Region of South Australia.	\$130.00		
		Dry Suit Diving. Everything including buoyancy, maintenance, choice, etc.	\$35.00		
		Australian Caving Diving - A Contrast. by Tony Carlisle. Four short documentary type videos on Warbla Cave, Three Sisters Cave, The Road to Toad Hall and Tank Cave. Reviewed in Guidelines 54.	\$25.00		
		Australia "Nullarbor Dreaming". A world record exploration into a desert cave. During November 1988, a team of Australian cave divers set out on an amazing adventure to explore the mysterious subterranean waters of the Panmink Plains caves. This epic underwater exploration nearly ended in tragedy when a freak cyclone storm hit the area and the cave collapsed trapping the expedition below. The program is a graphic account of the expedition and their escape from the cave. Executive Producer - Andrew Wight.	\$29.95		
		Florida "Window to a Hidden World". The ultimate cave diving adventure. Andrew and Liz with fellow cave diver-explorer Wes Skiles, take us on a journey to discover the beauty and danger of the Florida aquifer. Beneath the surface of Florida lies one of the planet's largest freshwater reserves. The intricate system of water filled caves is now under increasing environmental threat from the population above. Producers: Andrew & Liz Wight.	\$29.95		
		Mexico "Water of the Gods". An exploration of ancient Maya ruins and underwater caves. Under the dense jungle of Mexico's Yucatan Peninsula lies a vast freshwater source relied upon by the ancient Mayas - a mysterious and complex people who built and occupied complex limestone cities in this region for over two thousand years. The Wights explore their hidden caves, uncovering their beauty and mystery, and providing a link to the past. Producers: Andrew & Liz Wight. Director: Liz Wight.	\$29.95		
CLOTHING		Cuba "Beneath the Surface". The underworld of Cuba. This documentary explores the role water has played throughout time in the history of Cuba. It reveals some of the many beautiful aspects of this magical Caribbean island, explores the bizarre subterranean caverns and provides unexpected contrasts with Cuba's turbulent history. This is an expose of a Cuba we believe we know. Producers: Andrew & Liz Wight. Director: Liz Wight.	\$29.95		
		New Style T-Shirts. Colour: White, Blue. Sizes: Medium, Large, Extra Large.	\$25.00		
		New Style Windcheaters. Colours: Blue, Black. Sizes: Small, Medium, Large, Extra Large.	\$35.00		
		Polo Shirts. Colours: White, Blue, Black.	\$30.00		
		CDAA Key Rings. Blue with gold motif. CDAA P.O. Box on back.	\$5.00		
		CDAA Stickers. Yellow. (Include stamped, self-addressed envelope for delivery.)	\$8.00		
		Tank Cave Poster. Full Colour 14 1/2" x 25" poster of Tank Cave by Peter Rogers. Price includes p&h.	\$8.00		
		CDAA 25th Year Anniversary Stickers. Special deal - 3 for \$5	\$5.00		
	MISC.				

Cardholders Name: _____ Sub Total \$ _____
Address: _____ Plus postage & handling **\$6.00**
_____ Postcode: _____ **TOTAL \$** _____
Card No. [] ☐ Bankcard ☐ Mastercard ☐ Visa
Expiry Date: _____ Signature: _____ Ph: () _____ Fax: () _____



INTERNATIONAL MOTEL



Mount Gambier

"The Cave Divers home away from home"

Our Facilities Include:

- * 60 Ground Floor Units - Modern & Spacious
- * Licensed Restaurant - Extensive Dinner Menu
- * Huge indoor heated pool, spa & sauna
- * Austar multi channel pay TV free to all rooms
- * Secure floodlit off street parking
- * Quality Flag Accommodation
- * Late Check In available

SPECIAL DISCOUNTS TO CDAA MEMBERS

(Excluding Easter Weekend)

ROOMS FROM \$50 !!

**RING TOLL FREE ON 1800 088877
TO MAKE YOUR RESERVATION**

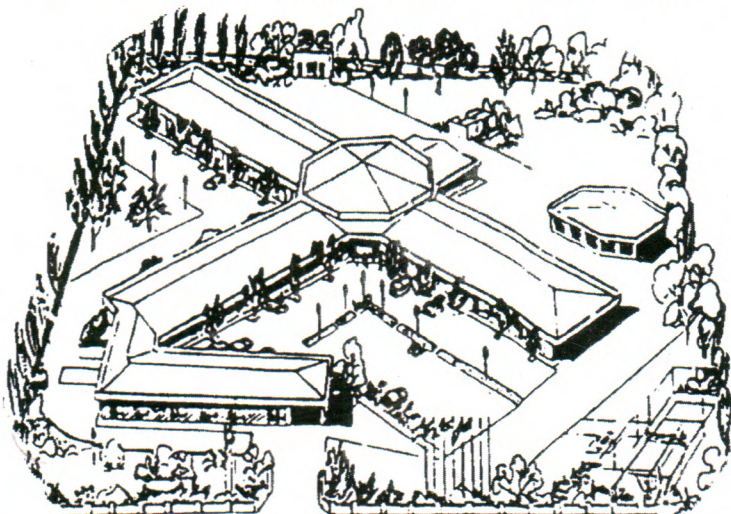

**OFFICIAL
CDAA
CORPORATE
SPONSOR**

**MT GAMBIER
INTERNATIONAL MOTEL
MILLICENT ROAD, MOUNT GAMBIER
TEL: 08 8725-9699 FAX: 08 8725-0843**

**OFFICIAL
CDAA
CORPORATE
SPONSOR**